

HINGES

Clamp-On Hinges	2
Two Part Hinges + Attachment	2
Two Part Interlocking Hinges + Attachment	2
Strap Type Hinges + Attachment	2
Two Part Hinge Gudgeons	3
Pipe Hinge Straps	3
Pipe Straps	3
Hinge Strap Attachments	3
Backing Plates	4
Gate Hinge Terminology	4
Rising Hinges	4
Double Butt Ball Bearing Hinge	5
Ball Bearing Security Hinge	5
Ball Bearing Gate Hinge	5
Ball Bearing Hinge - Bolt-On/Weld-On	6
Steel To Steel Ball Bearing Hinges	6
Security Bolt-On/Weld-On	6-7
Scotch T Hinges	7
Spring-Loaded Gate Hinges	8
Broad Butt Hinges	8
Narrow Butt Hinges	8
Aluminium Hinge	8
Multi-Fit Gate Hinges	9
Tru-Close Multi-Adjust Self Closing Hinges	9-12
Gate Hinge - Fixed, Adjustable & Self Closing	13
Gate Hinge Packs & Gate Packs	14-16
Gate Installation Guide	17
Hinge Bushes	18

GUDGEONS

Corner & Wall Gudgeons	19
Wall, Post & Self-Closing Gudgeons	20
Long Plate and Adjustable Gudgeons	21
Weld-On & Bolt-On Gudgeons	21
Bolt-On Gudgeons	21
Channel Gudgeons	22
Short Plate Wood Gudgeon	22
Loose Bolt Gudgeons	22

CATCHES, LATCHES & LOCKS

Gate Keeper	23
Two-Way Catches	23
'D' Latch, Strikers, Handles	23-24
Striker Anti Rattle Sleeve	25
'D' Latch Angle Bracket	25

Forte Hapslock & Pull Bolt	25-26
Broadhurst Lock Kit	26
Security Sliding Gate Lock	26
Jackson Mortise Locks & Cage	27
Lock & Handles	27-18
Spring Loaded Gate Lock	28
Anti Burglar 'D' Latch	28
Coil Spring	28
Hasp & Staple	28
Lock Block	29
Masterlock Security Gate Lock & Hasp	29
Shoot Padbolt	29
Lockable Drop Bolt	30
Side Release Gravity Latch	30
Double Gate Bow	30

SAFETY GATE LATCHES

Magna Latch	31
Lokk Latch - Gate Latch	31-32
Z-Lokk, Gate Stops, Lokk Bolt	32

BOLTS

Drop Bolts	33
Drop Bolt Lugs	34
Drop Bolt & Slide Plates	34-35
Shoot Bolt & Slide Plate	35
Gate Pad Bolts	35

GATE ACCESSORIES

Gate Brace, Entry Brace	36
-------------------------	----

CANTILEVER GATE HARDWARE

Wheels Carriages	37
Guides	37
Accessories	37-39
Cantilever Gate Component List	40

SLIDING GATE HARDWARE

Track	41
Wheels	42-43
Top Rollers/Guides	44-45
Stops	46
Sliding Gate Component List	46

SWING GATE HARDWARE

Hinges	47-51
Stops	51
Swing Gate Component List	52
Ball Bearing Selection Chart	53

* For terms & conditions of sale please read the last page of this catalogue

PIPE DIMENSIONS

NOMINAL BORE (ID) (NB)		OUTSIDE DIAMETER	
IMPERIAL	METRIC	IMPERIAL	METRIC
1/2 "	15 mm	27/32 " (0.844")	21.3 mm
3/4 "	20 mm	1 1/16 " (1.062")	26.9 mm
1 "	25 mm	1 11/32 " (1.343")	33.7 mm
1 1/4 "	32 mm	1 11/16 " (1.687")	42.4 mm
1 1/2 "	40 mm	1 29/32 " (1.906")	48.3 mm
2 "	50 mm	2 3/8 " (2.375")	60.3 mm
2 1/2 "	65 mm	3 " (3.000")	76.1 mm
3 "	80 mm	3 1/2 " (3.500")	88.9 mm
3 1/2 "	90 mm	4 " (4.000")	101.6 mm
4 "	100 mm	4 1/2 " (4.500")	114.3 mm
5 "	125 mm	5 " (5.000")	127.0 mm
6 "	150 mm	6 " (6.000")	152.4 mm

Unless otherwise specified all DOWNEE RMD component sizes relate to nominal pipe dimensions (NB)

CLAMP-ON HINGES - Galvanised

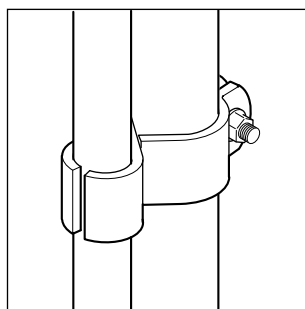
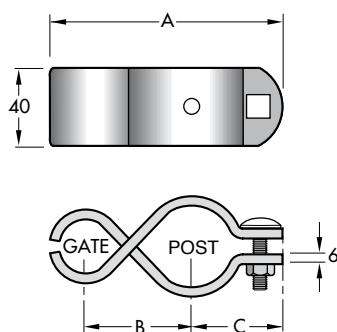

CODE	POST	GATE	A	B	C	CTN/PACK	KG
H2020	20	20	110	46	44	30(3x10)	14
H2520	25	20	118	50	48	30(3x10)	17
H2525	25	25	124	53	46	30(3x10)	19
H3220	32	20	127	54	52	30(3x10)	18
H3225	32	25	135	57	55	30(3x10)	20
H4020	40	20	135	57	58	30(3x10)	18
H5020	50	20	144	63	61	30(3x10)	20

- Supplied complete with Zinc Plated M10 x 40 Bolt and Nut.

TWO PART HINGES + ATTACHMENT - Galvanised

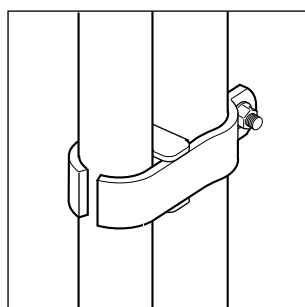
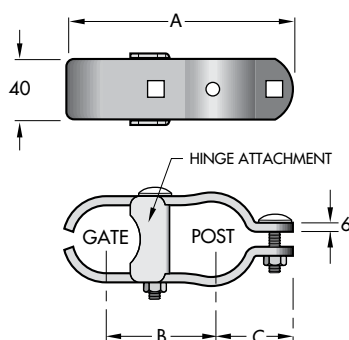

CODE	POST	GATE	BOLTS	ATTACH.	A	B	C	CTN/PACK	KG
H4025	40	25	M10X40 M10X60	HA25	140	60	56	30(3x10)	19
H4032	40	32	M10X40 M10X70	HA32	150	65	56	20(2x10)	12
H5032	50	32	M10X40 M10X70	HA32	160	71	61	20(2x10)	15

TWO PART INTERLOCKING HINGES + ATTACHMENT - Galvanised

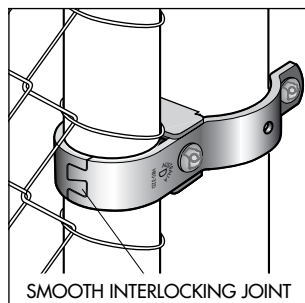
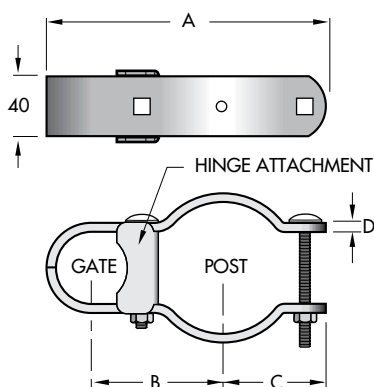

CODE	POST	GATE	BOLTS	ATTACH.	A	B	C	D	CTN/PACK	KG
# H5025D	50NB	25NB	M10X40 M10X60	HA25	150	66	61	5	20(5x4)	14
H8025D	80NB	25NB	M10X70 M10X80	HA25	174	81	69	6	14(7x2)	10
H8032D	80NB	32NB	M10X75 M10X75	HA32	183	85	69	6	14(7x2)	11

- Smooth interlocking joint eliminates mesh snagging and cutting.
- Australian Registered Design No. 128141
- # Available in powder coated finish (Black or Brunswick Green).

STRAP TYPE HINGES + ATTACHMENT - Galvanised

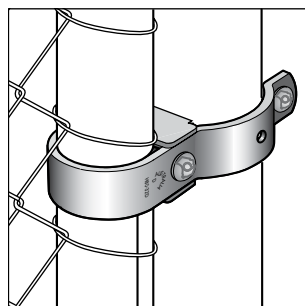
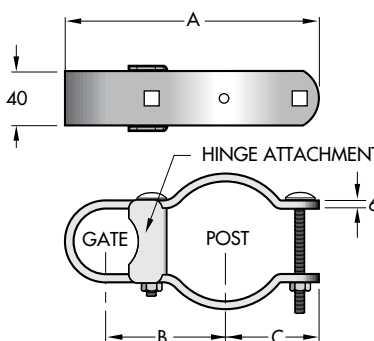

CODE	POST	GATE	BOLTS	ATTACH.	A	B	C	CTN	KG
H8040	80	40	M10X75 M10X85	HA40	190	92	69	10	10
H10025	100	25	M10X70 M10X85	HA25	200	100	82	10	11
H10032	100	32	M10X70 M10X85	HA32	210	100	82	10	12
H10040	100	40	M10X80 M10X85	HA40	216	101	84	10	12

TWO PART HINGE GUDGEONS - Galvanised

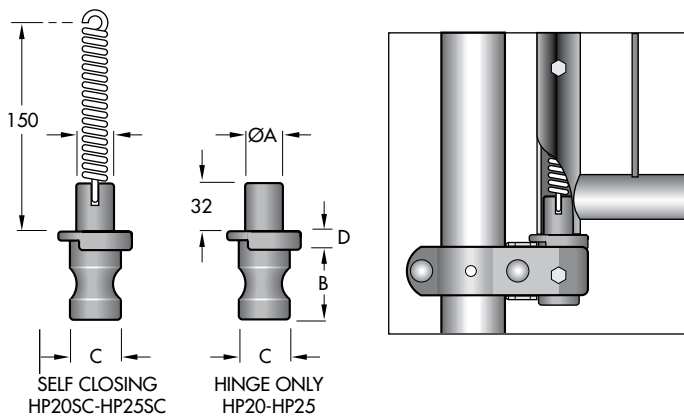

CODE	GATE	A	B	C	D	CTN/PACK	KG
SELF CLOSING							
HP25SC	25NB	24	48	34	12	20(2x10)	12
HINGE ONLY							
HP20	20NB	19	41	28	8	60	6
HP25	25NB	24	48	34	12	30	4

- 1 1/2 x 5/16 W Hex. Head Zinc Plated Bolt included with self closing gudgeons.
- Used with Two Part and Strap Type hinges.

PIPE HINGE STRAPS - Galvanised

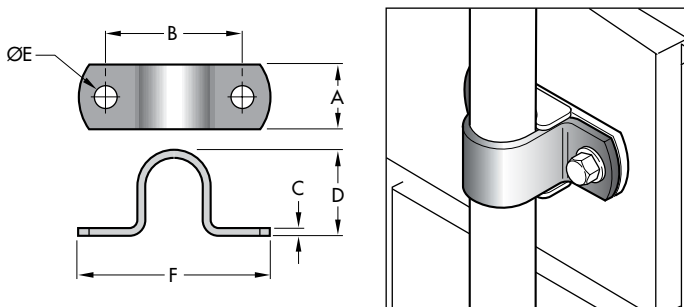

CODE	PIPE	FIT	A	B	C	D	E	F	CTN	KG
S1	20NB	HINGE	25	63	3	42	11	94	180	13
S2	25NB	HINGE	25	77	5	50	11	108	100	15
S3	25NB	HINGE	40	83	5	53	14	116	50	13
S4	32NB	HINGE	40	91	5	62	13	127	50	16
S5	40NB	HINGE	40	97	5	55	14	139	50	17
S6	50NB	HINGE	40	110	5	64	15	150	45	15

- Hinge Strap Attachments and Backing Plates are available for S1-S4 Hinge Straps, refer tables below.

PIPE STRAPS - Tight Fit - Galvanised

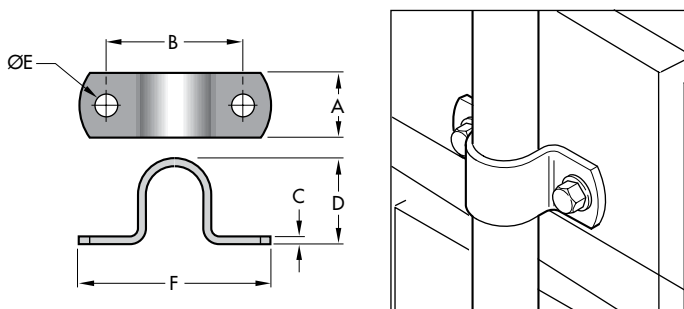

CODE	PIPE	FIT	A	B	C	D	E	CTN	KG
S1T	20NB	TIGHT	25	63	3	28	11	180	13
S2T	25NB	TIGHT	25	77	5	38	11	100	15
S3T	25NB	TIGHT	40	83	5	38	14	50	13
S4T	32NB	TIGHT	40	92	5	47	13	50	16
S5T	40NB	TIGHT	40	98	5	52	14	50	17
S6T	50NB	TIGHT	40	108	5	64	15	45	15

HINGE STRAP ATTACHMENTS - Galvanised

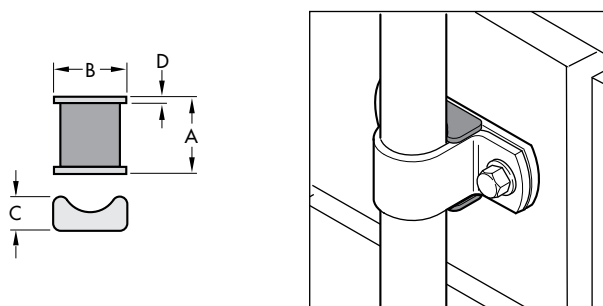

CODE	PIPE	A	B	C	D	TO SUIT	CTN	KG
A1	20NB	30	42	21	1.8	S1	400	13
A2	25NB	32	46	19	2.5	S2	360	15
A3	25NB	47	47	21	3	S3	200	15
A4	32NB	47	53	26	3	S4	150	15

- Use with Pipe Hinge Straps.

BACKING PLATES - Galvanised

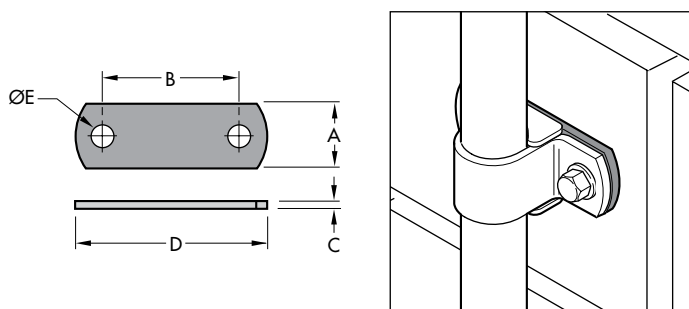

CODE	A	B	C	D	E	TO SUIT	CTN	KG
BP1	25	63	3	86	11	S1	300	14
BP2	25	77	5	98	11	S2	200	17
BP3	40	83	5	125	15	S3	100	12
BP4	40	91	5	135	15	S4	100	15

- Use with Pipe Hinge Straps.

GATE HINGE TERMINOLOGY

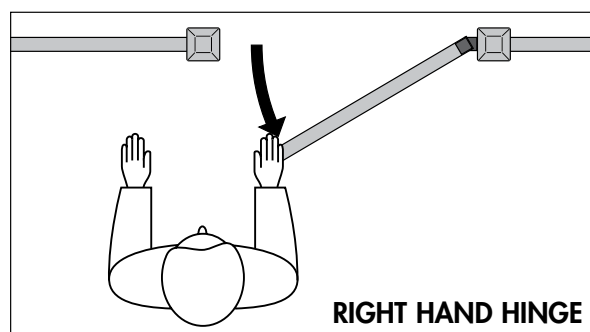
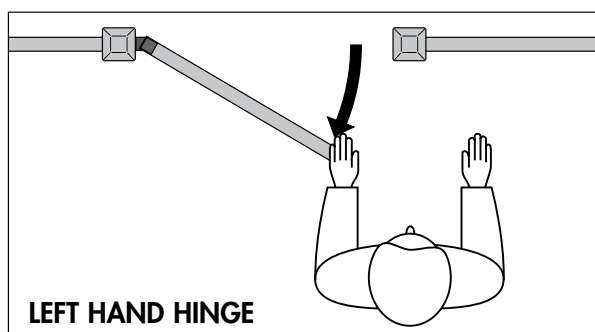

RISING HINGES - Zinc Plated

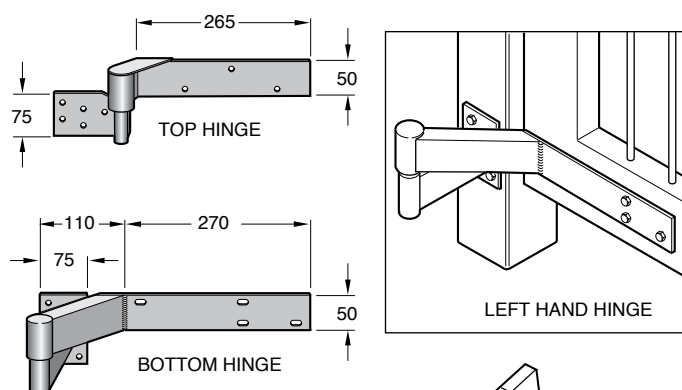

CODE	DESCRIPTION	CTN	KG
G7R	RIGHT HAND (TOP & BOTTOM HINGES)	1 PAIR	4
G7L	LEFT HAND (TOP & BOTTOM HINGES)	1 PAIR	4

- For gates up to 80Kg.
- Ball Bushing.
- Fixing instructions supplied.

EXAMPLE GATE RISE CHART

GATE HEIGHT 960 mm - HINGE SEPARATION 750 mm

GATE WIDTH	GATE RISE @ 90° OPENING
900 mm	275 mm
1200 mm	330 mm
1500 mm	400 mm
1800 mm	460 mm
2100 mm	530 mm

- Rise is totally dependent on gate width and hinge separation.
Above chart is one example only.

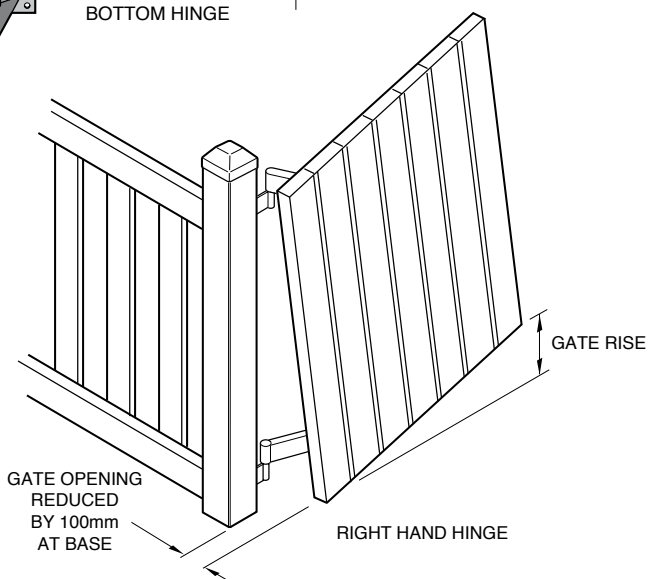

DOUBLE BUTT BALL BEARING HINGE - Bolt on - Zinc Plated

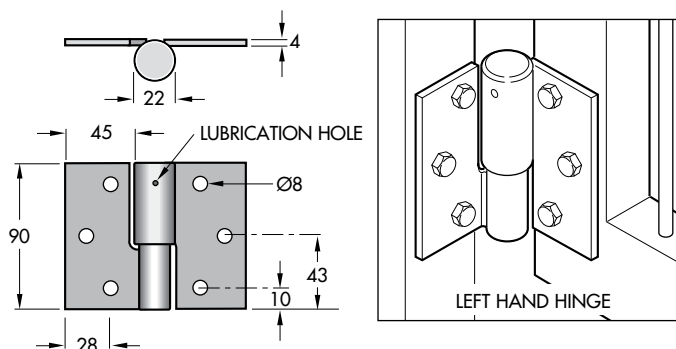

CODE	DESCRIPTION	CTN	KG
G8R	RIGHT HAND	10 PAIR	16
G8L	LEFT HAND	10 PAIR	16
G8SR	RIGHT HAND	25 PAIR	16
G8SL	LEFT HAND	25 PAIR	16

- For gates/doors up to 1000Kg.
- For smooth operation, hinges require regular lubrication.
- Spring loaded.

BALL BEARING SECURITY HINGE - Weld on - Heavy Duty - Zinc Plated

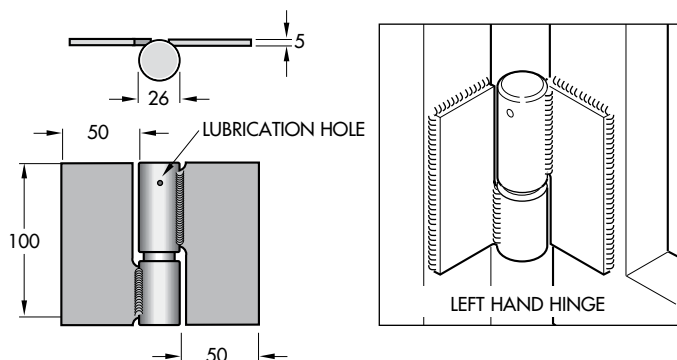

CODE	DESCRIPTION	CTN	KG
G121R	RIGHT HAND	10 PAIR	1.5
G121L	LEFT HAND	10 PAIR	1.5

- For gates/doors up to 1500Kg.
- For smooth operation, hinges require regular lubrication.

BALL BEARING GATE HINGE - Bolt-on - Zinc Plated & Galvanised

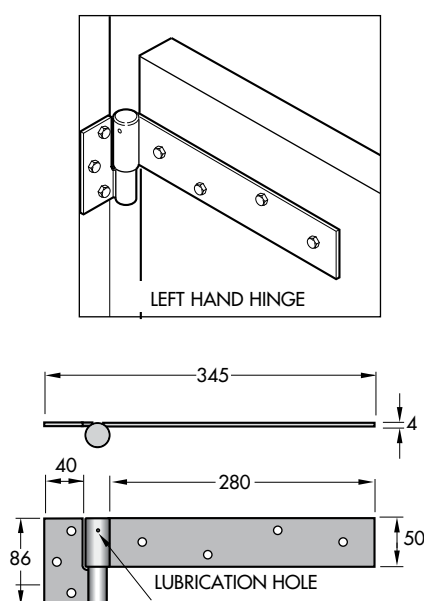

CODE	DESCRIPTION	FINISH	CTN	KG
G1R	RIGHT HAND	ZINC PLATED	12 PAIR	22
G1L	LEFT HAND	ZINC PLATED	12 PAIR	22
G1RGAL	RIGHT HAND	GALVANISED	12 PAIR	22
G1LGAL	LEFT HAND	GALVANISED	12 PAIR	22

- For gates/doors up to 1000Kg.
- For smooth operation, hinges require regular lubrication.

HEAVY DUTY BALL BEARING HINGE - Weld On - Zinc Plated

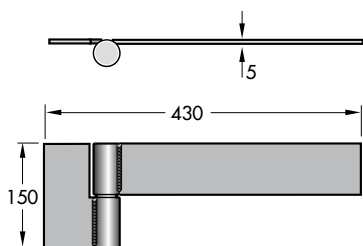

CODE	DESCRIPTION	CTN	KG
G136R	RIGHT HAND	1 PAIR	2
G136L	LEFT HAND	1 PAIR	2

- For gates/doors up to 1500Kg.
- For smooth operation, hinges require regular lubrication.

BALL BEARING HINGE - Bolt-on/Weld-on - Zinc Plated & Galvanised

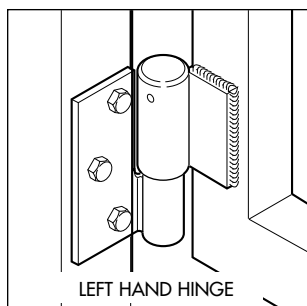
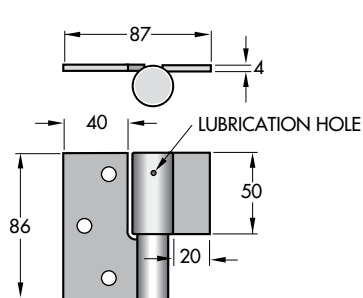

CODE	DESCRIPTION	FINISH	CTN	KG
G4R	RIGHT HAND	ZINC PLATED	20 PAIR	15
G4L	LEFT HAND	ZINC PLATED	20 PAIR	15
G4RGAL	RIGHT HAND	GALVANISED	20 PAIR	15
G4LGAL	LEFT HAND	GALVANISED	20 PAIR	15

- For gates/doors up to 1000kg.
- For smooth operation, hinges require regular lubrication.

STEEL TO STEEL BALL BEARING HINGES - Weld on - Zinc Plated

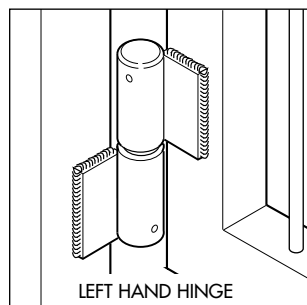
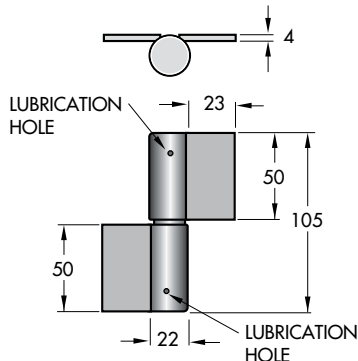

CODE	DESCRIPTION	CTN	KG
G4DR	RIGHT HAND	25 PAIR	3
G4DL	LEFT HAND	25 PAIR	3

- Double ball bearings hinges.
- For gates/doors up to 1000Kg.
- For smooth operation, hinges require regular lubrication.

SECURITY BOLT-ON BEARING HINGE - Zinc Plated

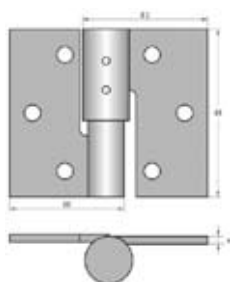

CODE	DESCRIPTION	CTN	KG
T2200RHB	RIGHT HAND	10 PAIR	9
T2200LHB	LEFT HAND	10 PAIR	9

- For gates/doors up to 1000kg.
- For smooth operation, hinges require regular lubrication.
- Gate cannot be lifted off hinge when gate is in a closed position.

SECURITY BOLT-ON/WELD ON BEARING HINGE - Zinc Plated

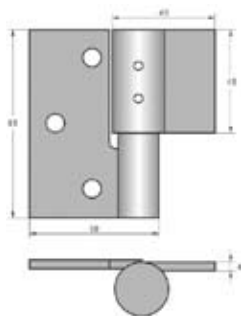

CODE	DESCRIPTION	CTN	KG
T2100RHB	RIGHT HAND	10 PAIR	8
T2100LHB	LEFT HAND	10 PAIR	8

- For gates/doors up to 1000kg.
- For smooth operation, hinges require regular lubrication.
- Gate cannot be lifted off hinge when gate is in a closed position.

SECURITY WELD-ON BEARING HINGE - Zinc Plated

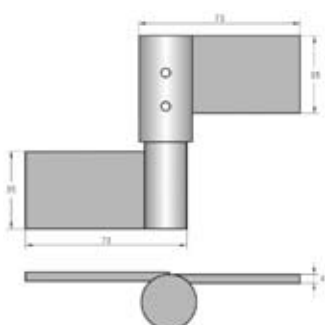

CODE	DESCRIPTION	CTN	KG
T2400RHB	RIGHT HAND	10 PAIR	8
T2400LHB	LEFT HAND	10 PAIR	8

- For gates/doors up to 1000kg.
- For smooth operation, hinges require regular lubrication.
- Gate cannot be lifted off hinge when gate is in a closed position.

SECURITY BOLT-ON HEAVY DUTY BEARING HINGE - Zinc Plated

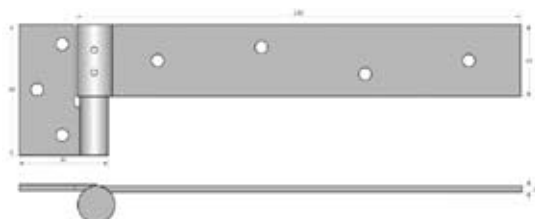

CODE	DESCRIPTION	CTN	KG
T2000RHB	RIGHT HAND	10 PAIR	15
T2000LHB	LEFT HAND	10 PAIR	15

- For gates/doors up to 1000kg.
- For smooth operation, hinges require regular lubrication.
- Gate cannot be lifted off hinge when gate is in a closed position.

SCOTCH T HINGES - Galvanised - Brass Pin

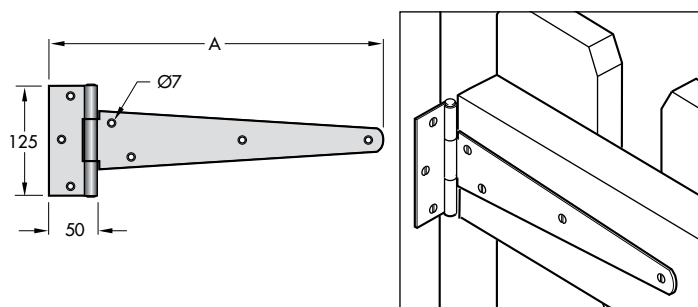

CODE	A	CTN	KG
H150G	150	24 PAIR	5
H200G	200	12 PAIR	7
H250G	250	20 PAIR	10
H300G	300	20 PAIR	11

SPRING LOADED GATE HINGE - Zinc Plated / Stainless Steel

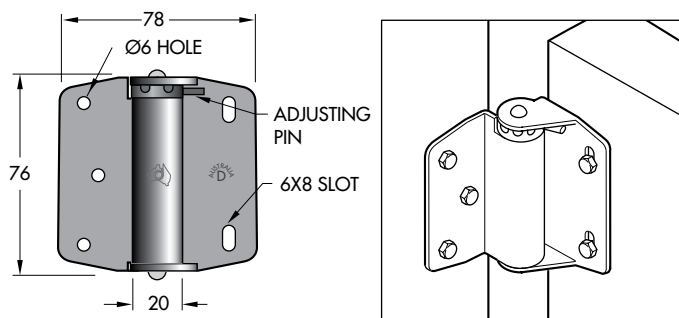

CODE	MATERIAL	CTN	KG
PH75	ZINC PLATED STEEL	60 PAIR	8
PH75SS	316 STAINLESS STEEL	30 PAIR	8

- For gates up to 80kg.
- Easily adjustable tension.
- Compatible with all Gate and Post materials.

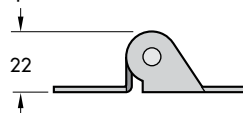

BROAD BUTT HINGES - Zinc Plated, Stainless Steel & Nylon

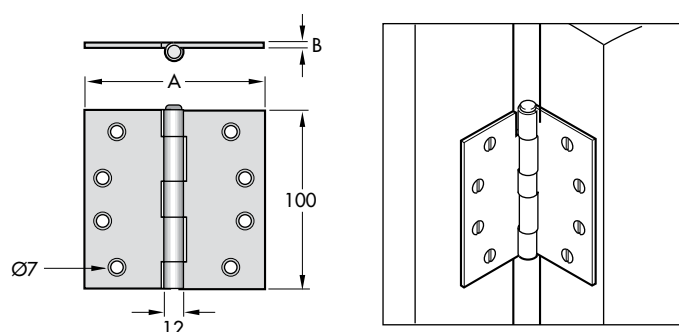

CODE	A	B	TYPE	MATERIAL	CTN	KG
HEAVY DUTY BUTT HINGES						
HLP100X75	75	2.5	LOOSE PIN	ZINC PL.	40 PAIRS	12
HFP100X75	75	2.5	FIXED PIN	ZINC PL.	40 PAIRS	12
HLP100X100	100	2.5	LOOSE PIN	ZINC PL.	40 PAIRS	12
HFP100X100	100	2.5	FIXED PIN	ZINC PL.	40 PAIRS	12
HSS10075	75	3	FIXED PIN	S/STEEL	48 PAIRS	5
HSS100100	100	3	FIXED PIN	S/STEEL	48 PAIRS	5
MID DUTY BUTT HINGES						
TCP	86	5	FIXED PIN	NYLON	20 PAIR	2

NARROW BUTT HINGES - Loose Pin - Zinc Plated/Brown

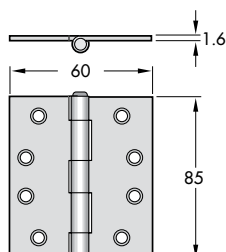

CODE	SIZE	FINISH	CTN	KG
NBZP8560	85x60mm	ZINC PLATED	1 PAIR	0.17
NBB8560	85x60mm	BROWN	1 PAIR	0.17

ALUMINIUM HINGE



ALH02

CODE	TYPE	SIZE	CTN	KG
ALH02	BUTT HINGE	100x75mm	10	2.5
# ALH02-MF	BUTT HINGE	100x75mm	10	2.5

Unassembled version for ease of powercoating.

HINGE - Aluminium - Weld On



CODE	SIZE	CTN	KG
VAH	30x120	25	10

MULTI-FIT - General Purpose Gate Hinges

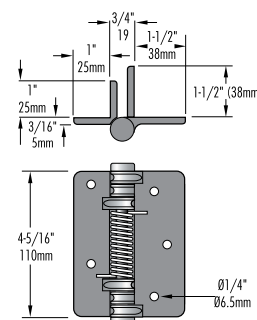
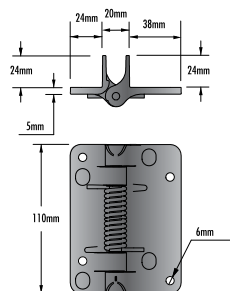
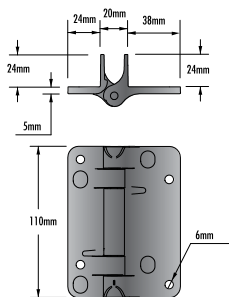

CODE	MAX GATE	SIZE	LEAF	CTN
PLAIN (NO SPRING) - POST OR WALL FIXING				
KFP	20kg	110x82mm	38/25mm	50pr
SELF CLOSING - FIXED TENSION - POST FIXING ONLY				
KFS	20kg	110x82mm	38/25mm	50pr
1 x PLAIN (KFP) + 1 x SELF CLOSING (KFS)				
KFPS	20kg	100x82mm	38/25mm	50pr
SELF CLOSING - ADJUSTABLE TENSION - POST OR WALL FIXING				
KFA	12kg	110x82mm	38/25mm	50pr
KFCAP	SAFETY CAP TO SUIT ALL MULTI-FIT MODELS EACH			

TRU-CLOSE MULTI ADJUST SELF CLOSING GATE HINGES - Heavy Duty Range

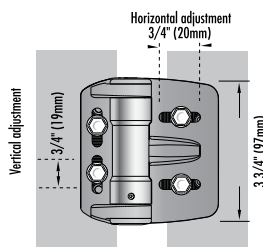
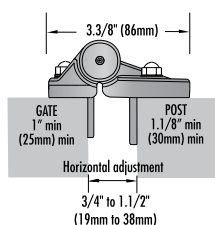

CODE	MAX GATE	SIZE	LEAF	CTN
TCHMA1	60kg	125x105mm	50/35mm	10pr

TRU-CLOSE SELF CLOSING HINGES - Standard Range

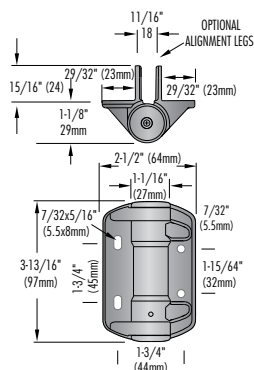

TCA1

CODE	MAX GATE	SIZE	LEAF	CTN
TCA1	25kg	90x66mm	24/24mm	20
TCA2	25kg	90x104mm	24/62mm	10
TCA3	25kg	90x143mm	62/62mm	10

TENSION ADJUSTABLE - SELF CLOSING - WITH 2 QUIK FIT ALIGNMENT LEGS

TCA1L2	25kg	90x66mm	24/24mm	20
TCA2L2	25kg	90x104mm	24/62mm	10
TCA3L2	25kg	90x143mm	62/62mm	10

TCACAP	Safety Cap to suit all TCA Models			125
--------	-----------------------------------	--	--	-----

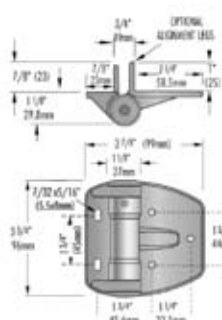

TCA2

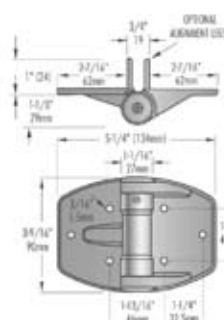

TCA3

TRU-CLOSE ROUND POST SELF CLOSING GATE HINGES - Heavy Duty Range

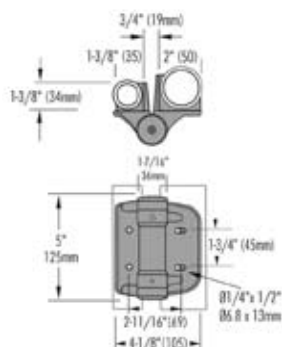

TCHDRND1

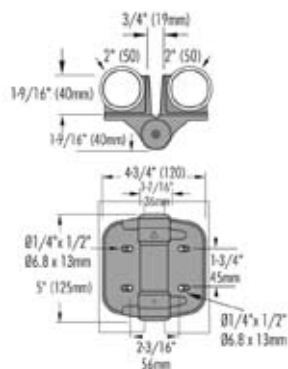

TCHDRND2

CODE	MAX GATE	SIZE	LEAF	CTN
TENSION ADJUSTABLE - SELF CLOSING				
TCHDRND1	60kg	125x105mm	50/35mm	10pr
TCHDRND2	60kg	125x105mm	50/50mm	10pr

TRU-CLOSE SELF CLOSING HINGES - Heavy Duty Range

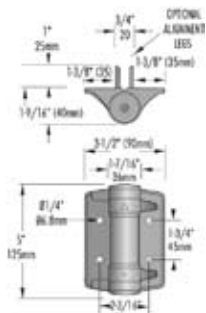

TCHD1A

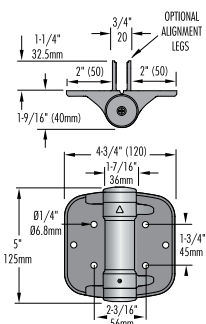

TCHD1

CODE	MAX GATE	LEGS	SIZE	LEAF	CTN
TCHD1A	60kg	None	125x87mm	34/34mm	40pr
TCHD1A-L1	60kg	1 Leg	125x87mm	34/34mm	40pr
TCHD1A-L2	60kg	2 Legs	125x87mm	34/34mm	40pr
TCHD1	60kg	None	125x120mm	50/50mm	35p
*TCHD1-L1	60kg	1 Leg	125x120mm	50/58mm	35p
*TCHD1-L2	60kg	2 Legs	125x120mm	50/50mm	35p
TCHD2	60kg	None	125x176mm	78/86mm	30p
*TCHD2-L2	60kg	2 Legs	125x176mm	78/78mm	30p
*TCHD2-L1S	60kg	1 Leg #	125x176mm	78/86mm	30p
TCHDCAP	Safety Cap to suit all TCH Models				

* Non stock item. Available to order only. Minimum order one (1) carton.

Slotted on the leaf without leg for fixing adjustment.

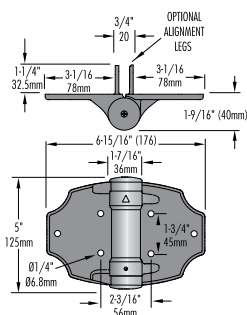

TCHD2

TRU-CLOSE MINI-MULTI ADJUST SELF CLOSING GATE HINGES - Fixing & Tension Adjustable

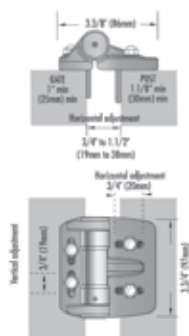

CODE	MAX GATE	SIZE	CTN
FIXING ADJUSTABLE			
TCAMA1	25kg	97x86mm	25

TRU-CLOSE SELF CLOSING HINGES - Heavy Duty Range

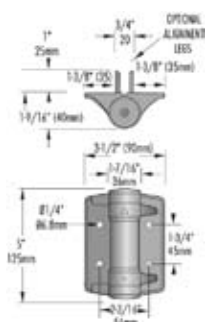

TCHD1A

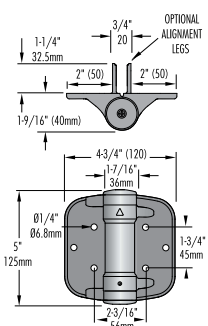

TCHD1

CODE	MAX GATE	LEGS	SIZE	LEAF	CTN
TCHD1A	60kg	None	125x87mm	34/34mm	40pr
TCHD1A-L1	60kg	1 Leg	125x87mm	34/34mm	40pr
TCHD1A-L2	60kg	2 Legs	125x87mm	34/34mm	40pr
TCHD1	60kg	None	125x120mm	50/50mm	35p
*TCHD1-L1	60kg	1 Leg	125x120mm	50/58mm	35p
*TCHD1-L2	60kg	2 Legs	125x120mm	50/50mm	35p
TCHD2	60kg	None	125x176mm	78/86mm	30p
*TCHD2-L2	60kg	2 Legs	125x176mm	78/78mm	30p
*TCHD2-L1S	60kg	1 Leg #	125x176mm	78/86mm	30p
TCHDCAP	Safety Cap to suit all TCH Models				

* Non stock item. Available to order only. Minimum order one (1) carton.

Slotted on the leaf without leg for fixing adjustment.

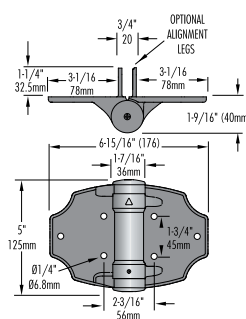

TCHD2

TRU-CLOSE MINI-MULTI ADJUST SELF CLOSING GATE HINGES - Fixing & Tension Adjustable

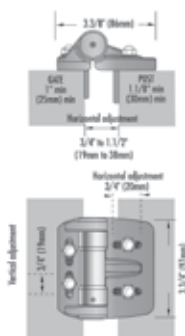

CODE	MAX GATE	SIZE	CTN
FIXING ADJUSTABLE			
TCAMA1	25kg	97x86mm	25

GATE HINGES - Fixed Pin - Zinc Plated

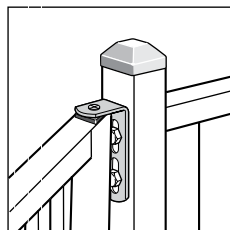
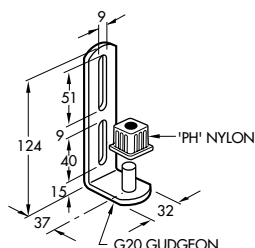

CODE	TUBE	HINGE BUSH	CTN/PACK	KG
G2525	25x25x1.2	PH2525	60(12x5)	13
G3030	30x30x1.2	PH3030	60(12x5)	13
G3825	38x25x1.2	PH3835	60(12x5)	13

- Used as either top or bottom fixed hinge.
- Refer page 19 for installation guide - Fixed and Adjustable Hinges.

GATE HINGES - Adjustable Pin - Zinc Plated

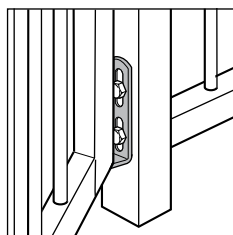
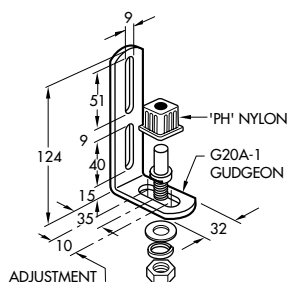

CODE	TUBE	HINGE BUSH	CTN/PACK	KG
G2525A	25x25x1.2	PH2525	60(12x5)	15
G3030A	30x30x1.2	PH3030	60(12x5)	15
G3825A	38x25x1.2	PH3825	60(12x5)	15

- Used as bottom hinge with variable adjustment for gate alignment.
- Refer page 19 for installation guide - Fixed and Adjustable Hinges.

BALL BEARING GATE HINGE - Bolt-on - Zinc Plated & Galvanised

WASHER INCLUDED
WITH G3030 & G3825

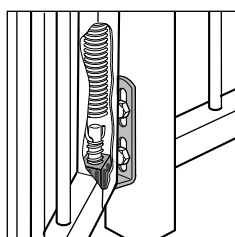
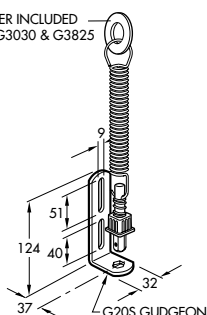

CODE	TUBE	HINGE BUSH	CTN/PACK	KG
G2525S	25x25x1.2	PH2525	30(10x3)	13
G3030S	30x30x1.2	PH3030	30(10x3)	13
G3825S	38x25x1.2	PH3825	30(10x3)	13

- Closing tension is adjustable with hinge used either top or bottom.
- Refer page 19 for installation guide - Fixed and Adjustable Hinges.

SELF CLOSING HINGES - Adjustable Pin - Zinc Plated

WASHER INCLUDED
WITH G3030 & G3825

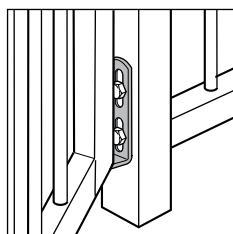
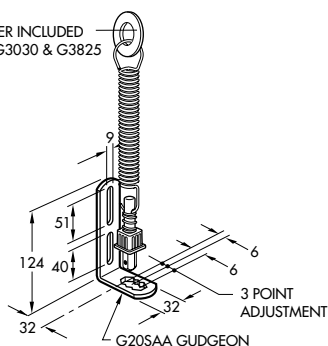

CODE	TUBE	HINGE BUSH	CTN/PACK	KG
G2525SA	25x25x1.2	PH2525	30(10x3)	13
G3030SA	30x30x1.2	PH3030	30(10x3)	13
G3825SA	38x25x1.2	PH3825	30(10x3)	13

- Closing tension and gate alignment are adjustable with hinge used either top or bottom.
- Registered Design. No. 117143
- Refer page 19 for installation guide - Fixed and Adjustable Hinges.

FIXED HINGE PACKS - Zinc Plated

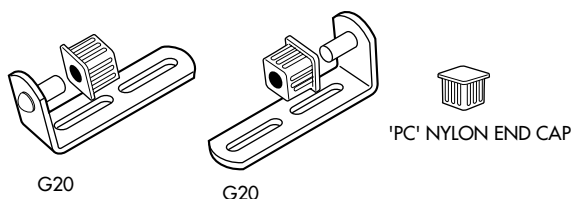

CODE	TUBE	HINGE BUSH	CAP	CTN	KG
TOP & BOTTOM					
G25A	25x25x1.2	2xPH2525	PC2525	35	15
G30A	30x30x1.2	2xPH3030	PC3030	35	15
G38A	38x25x1.2	2xPH3825	PC3825	35	15

- Fixed top and bottom hinges.
- Refer page 19 for installation guide

ADJUSTABLE HINGE PACKS - Zinc Plated

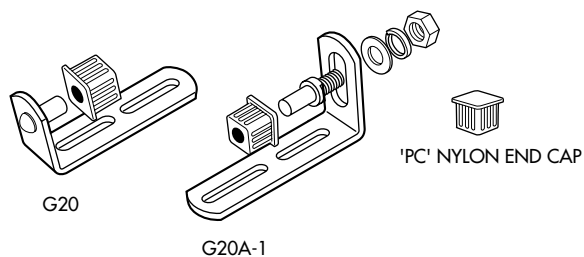

CODE	TUBE	HINGE BUSH	CAP	CTN	KG
FIXED TOP					
G25B	25x25x1.2	2xPH2525	PC2525	30	15
G30B	30x30x1.2	2xPH3030	PC3030	30	15
G38B	38x25x1.2	2xPH3825	PC3825	30	15

- Fixed top hinge & variable adj. bottom hinge for gate alignment.
- Refer page 19 for installation guide.

FIXED SELF CLOSING HINGE PACKS - Zinc Plated

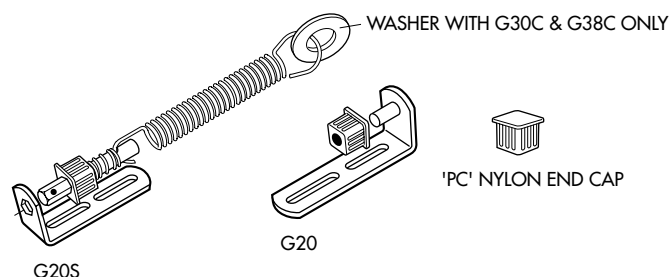

CODE	TUBE	HINGE BUSH	CAP	CTN	KG
G25C	25x25x1.2	2xPH2525	PC2525	20	13
G30C	30x30x1.2	2xPH3030	PC3030	20	13
G38C	38x25x1.2	2xPH3825	PC3825	20	13

- Fixed top hinge with adj. self closing tension & fixed bottom hinge.
- Refer page 19 for installation guide.

ADJUSTABLE VARIABLE SELF CLOSING HINGE PACKS - Zinc Plated

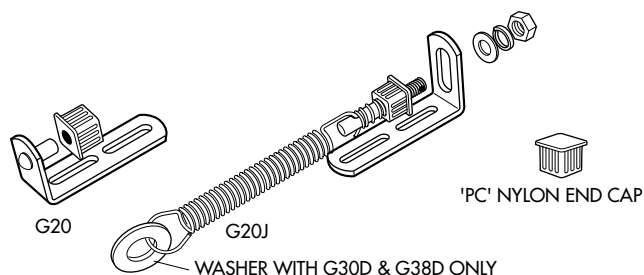

CODE	TUBE	HINGE BUSH	CAP	CTN	KG
G25D	25x25x1.2	2xPH2525	PC2525	20	13
G30D	30x30x1.2	2xPH3030	PC3030	20	13
G38D	38x25x1.2	2xPH3825	PC3825	20	13

- Fixed top hinge & adjustable bottom hinge for gate alignment.
- Refer page 19 for installation guide.

ADJUSTABLE VARIABLE SELF CLOSING HINGE PACKS - Zinc Plated

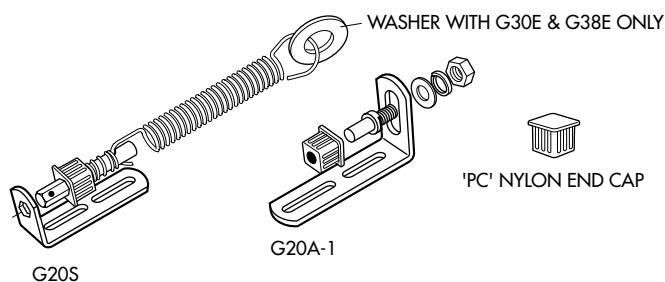

CODE	TUBE	HINGE BUSH	CAP	CTN	KG
G25E	25x25x1.2	2xPH2525	PC2525	20	14
G30E	30x30x1.2	2xPH3030	PC3030	20	14
G38E	38x25x1.2	2xPH3825	PC3825	20	14

- Fixed hinge with adjustable closing tension.
- Variable adjustment bottom hinge for gate alignment.
- Refer page 19 for installation guide.

ADJUSTABLE 3 POINT SELF CLOSING HINGE PACK - Zinc Plated

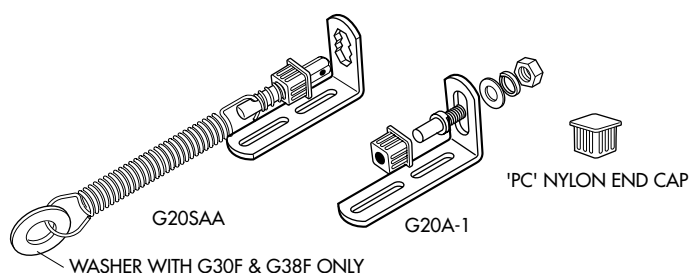

CODE	TUBE	HINGE BUSH	CAP	CTN	KG
G25F	25x25x1.2	2xPH2525	PC2525	20	14
G30F	30x30x1.2	2xPH3030	PC3030	20	14
G38F	38x25x1.2	2xPH3825	PC3825	20	14

- Adjustable top hinge.
- Exclusive 3 point adjustable bottom hinge for gate alignment together with adjustable closing tension.

SINGLE GATE PACKS - Zinc Plated - Metal Tube Gates

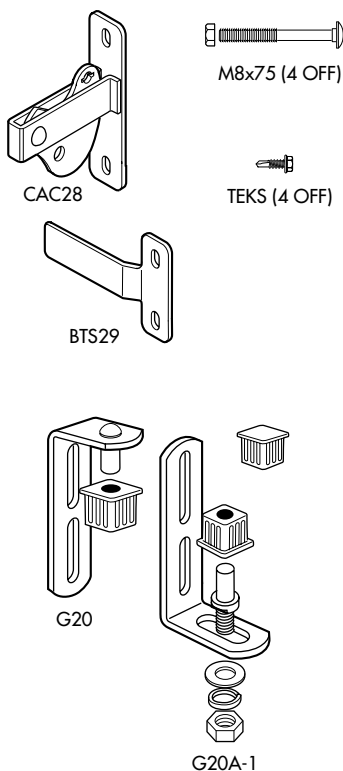

CODE	TUBE	HINGE BUSH	CAP	CTN/PACK	KG
SGP25	25x25x1.2	2xPH2525	PC2525	15(15x1)	13
SGP30	25x25x1.2	2xPH3030	PC3030	15(15x1)	13
SGP38	25x25x1.2	2xPH3825	PC3825	15(15x1)	13

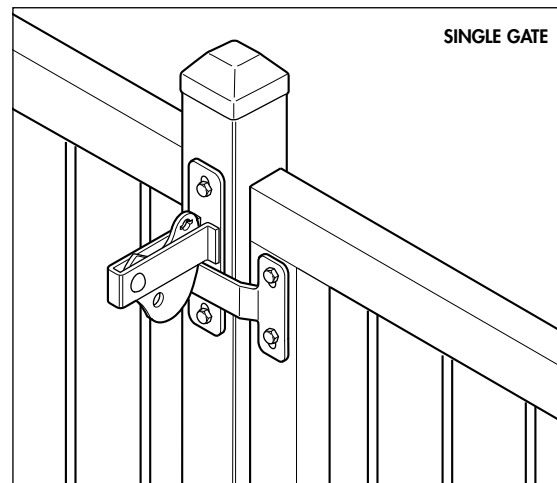

IMPORTANT: Latching system not suitable for pool gates

DOUBLE GATE PACKS - Zinc Plated - Metal Tube Gates

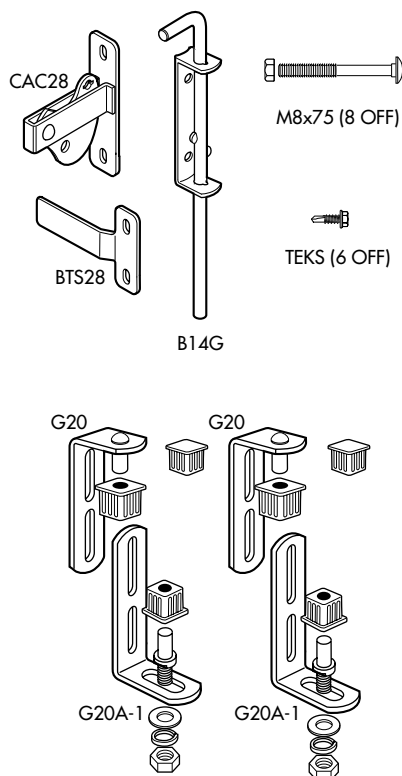

CODE	TUBE	HINGE BUSH	CAP	CTN/PACK	KG
DGP25	25x25x1.2	4xPH2525	2xPC2525	8(8x1)	15
DGP30	30x30x1.2	4xPH3030	2xPC3030	8(8x1)	15
DGP38	38x25x1.2	4xPH3825	2xPC3825	8(8x1)	15

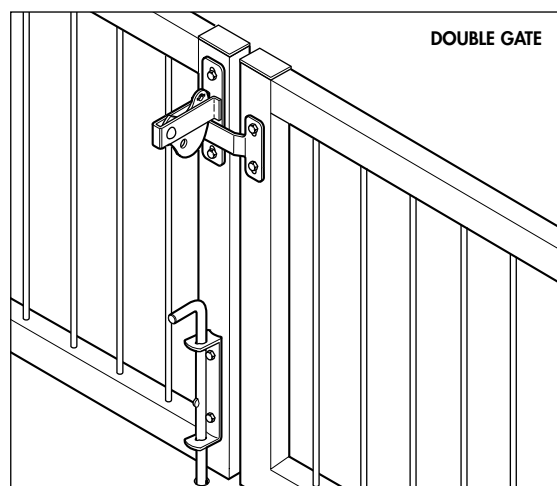

IMPORTANT: Latching system not suitable for pool gates

GATE INSTALLATION GUIDE

TYPICAL FIXED/ADJUSTABLE HINGE INSTALLATION

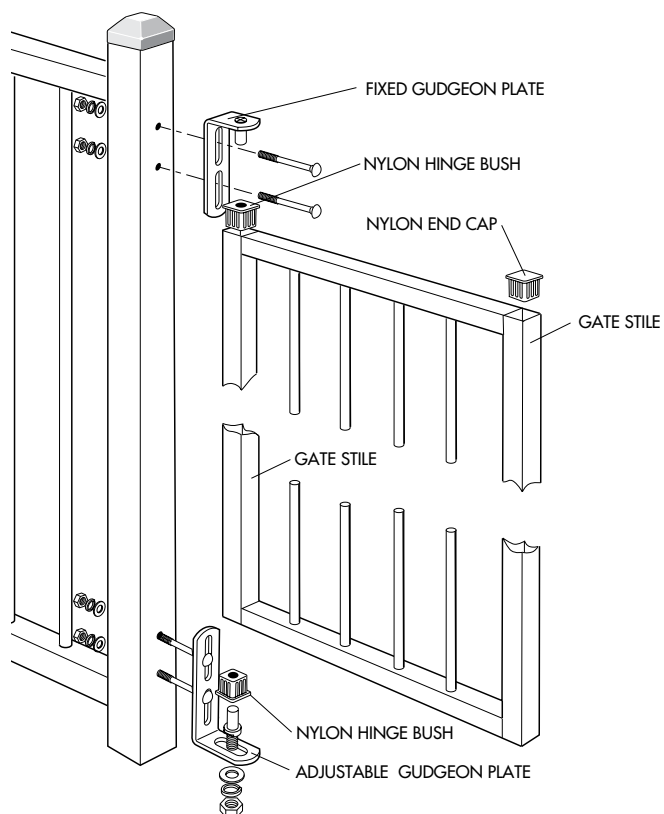

TYPICAL SELF CLOSING HINGE INSTALLATION

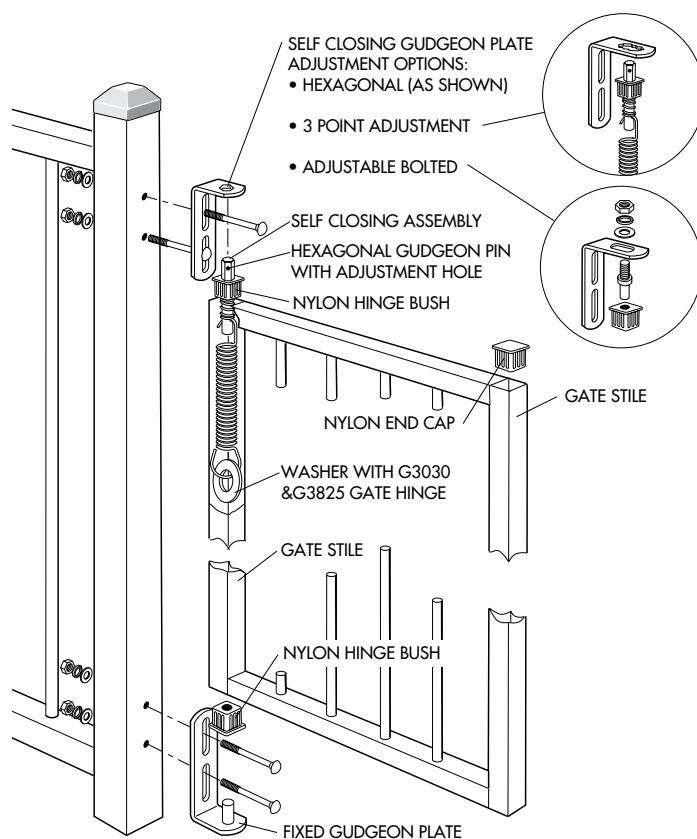

NOTE: BOTH THE ADJUSTABLE GUDGEON PLATE & FIXED GUDGEON PLATE CAN BE INTERCHANGED FOR TOP OR BOTTOM FIXING

HINGE BUSHES - 12mm - Black Nylon & White Polyethylene

MID DUTY

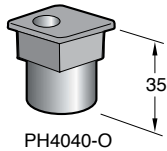
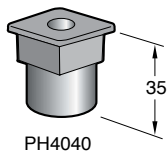

LIGHT DUTY

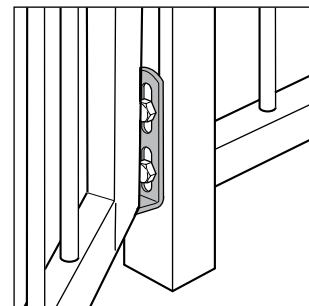
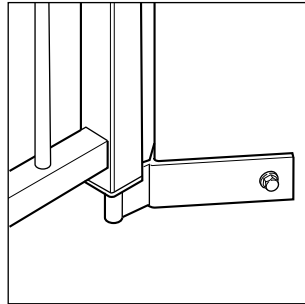
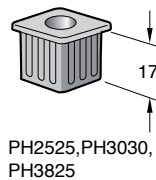

CODE	TUBE	MATERIAL	CTN	KG
PH2525	25x25	BLACK NYLON	200	2
PH3030	30x30	BLACK NYLON	200	2
PH3825	38x25	BLACK NYLON	200	2
PH4040	40x40	WHITE POLYETHYLENE	50	6
PH4040-O	40x40	WHITE POLYETHYLENE	50	6

- Use with all Ø12mm pin Gudgeons.
- PH4040-O Offset Hinge Bush allows 180° gate swing.

BEARING HINGE BUSHES - 19mm - White Polyethylene

HEAVY DUTY

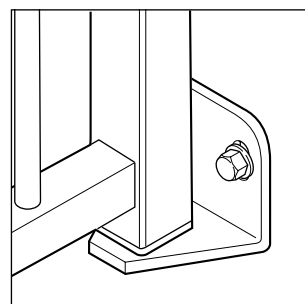
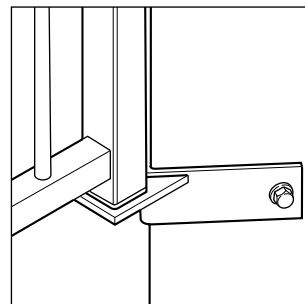
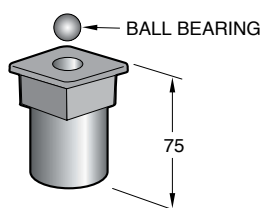

CODE	TUBE	CARTON	KG
PH4040-19	40x40	50	6
PH5050-19	50x50	50	9

- Use with all Ø19mm pin Gudgeons.
- Heavy duty applications.

CORNER GUDGEON - Adjustable - Heavy Duty - Zinc Plated

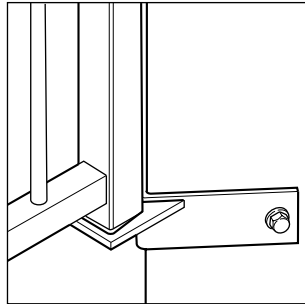
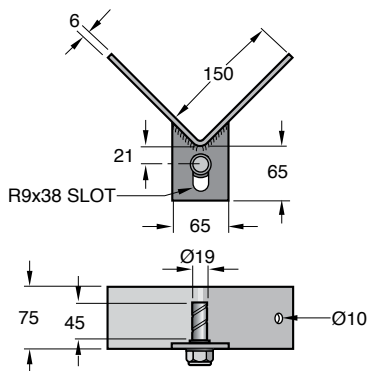

CODE	CTN	KG
GAHHDC	5 PAIR	15

- Use with Ø19mm Bearing Hinge Bushes or 20NB pipe to form a gate hinge.
- Allows for 270° of gate swing.

CORNER GUDGEON - Fixed - Mid Duty - Zinc Plated

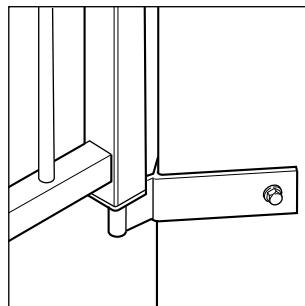
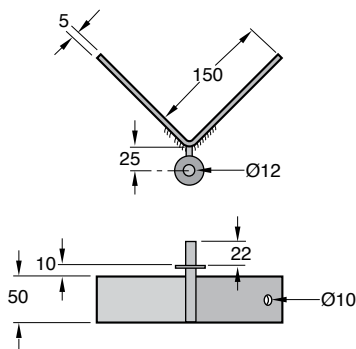

CODE	CTN	KG
GAHMDC	10 PAIR	14

- Use with Ø12mm Hinge Bushes to form a gate hinge.
- Allows for 270° of gate swing.

WALL GUDGEON - Fixed Pin - Mid Duty - Zinc Plated

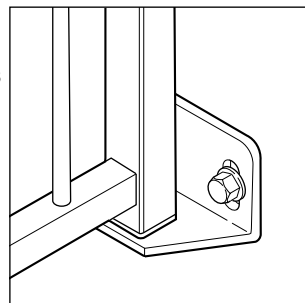
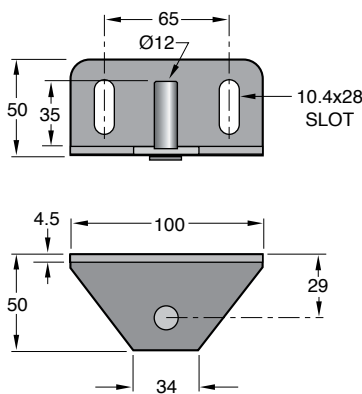

CODE	CTN	KG
GAHMDF	25 PAIR	15

- Wall mounting.
- Use with Ø12mm Nylon Hinge Bushes.

WALL GUDGEON - Adjustable - Mid Duty - Zinc Plated

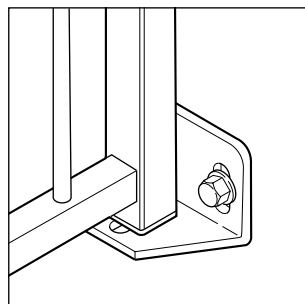
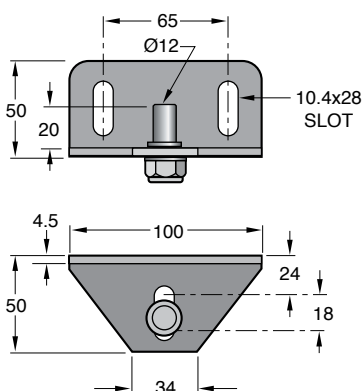

CODE	CTN	KG
GAHMDA	25 PAIR	16

- Wall mounting.
- Use with Ø12mm Nylon Hinge Bushes.

WALL GUDGEON - Adjustable - Heavy Duty - Zinc Plated

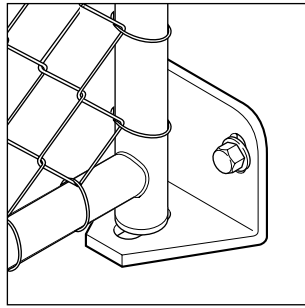
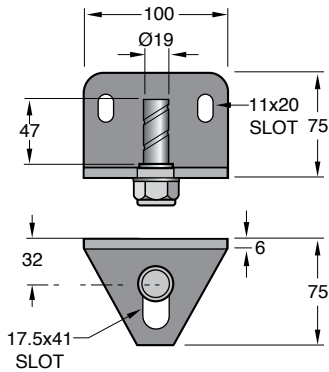

CODE	CTN	KG
GAHDA100	10 PAIR	15

- Wall mounting.
- Use with 20NB Pipe or Ø19 Nylon Bearing Hinge Bushes.

POST GUDGEON - Adjustable - Heavy Duty - Zinc Plated

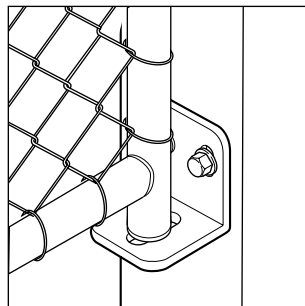
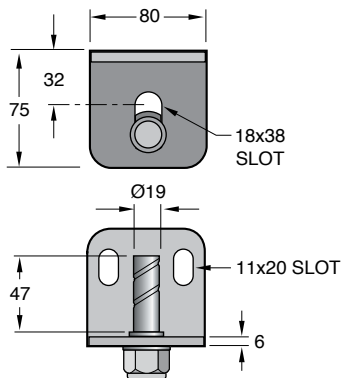

CODE	CTN	KG
GAHDA75	10 PAIR	14

- Post mounting.
- Use with 20NB Pipe or Ø19 Nylon Bearing Hinge Bushes.

SELF CLOSING GATE GUDGEON - Round - Galvanised

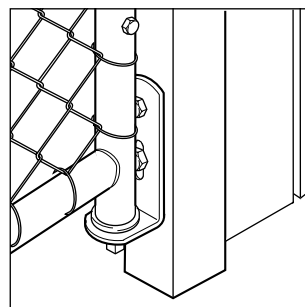
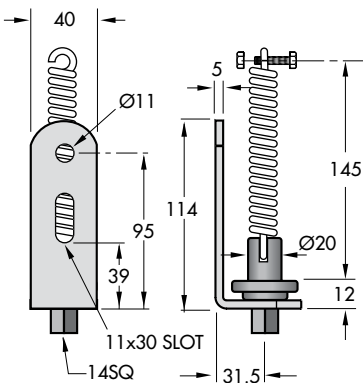

CODE	PIPE	BOLT	CTN/PACK	KG
GH20SC	20NB	1 1/2" X 5/16"	30(2X15)	11

LONG PLATE GUDGEONS - Fixed Pin - Bolt on - Galvanised

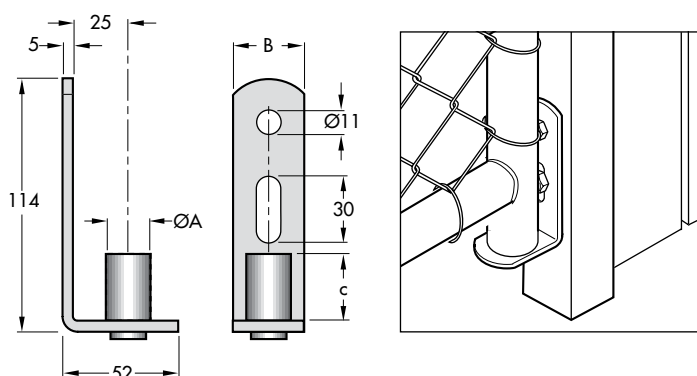

CODE	PIPE	A	B	C	CTN	KG
G12	20NB	19	32	32	60	15
G12W	20NB	19	40	32	60	18
G13	25NB	25	32	32	50	15
# G14	-	-	32	-	70	10
G15	32NB	27	32	32	40	15
G16	15NB	12	32	21	70	14

G14 has Ø15mm - NO PIN.

ADJUSTABLE LONG PLATE GUDGEONS - Bolt on - Zinc Plated

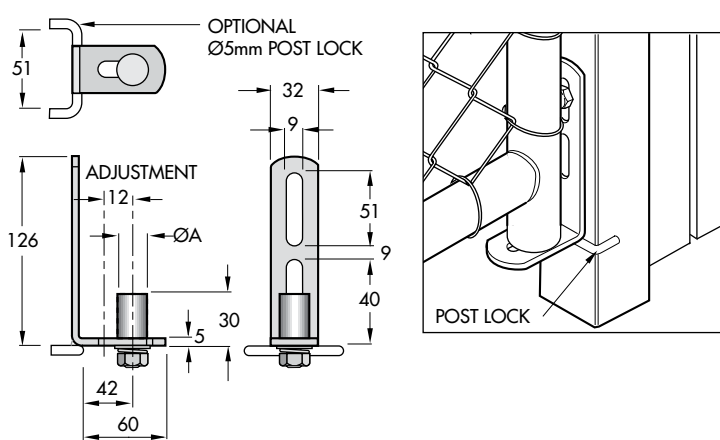

CODE	PIPE	A	CTN	KG
G1812	15NB	12	50	13
G1820	20NB	19	50	14
G1825	25NB	19	50	17

- Adjustable for gate alignment.

WELD-ON GUDGEONS - Galvanised

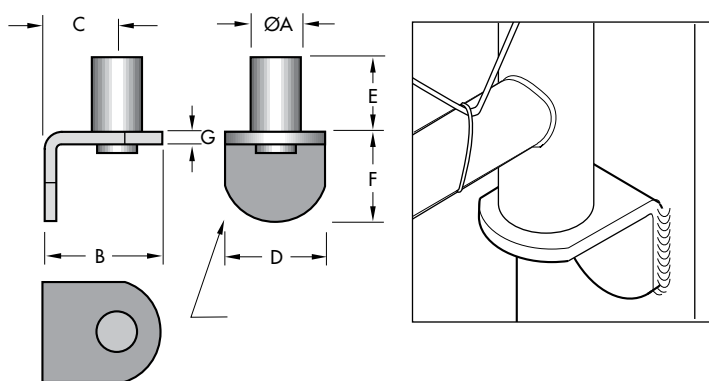

CODE	PIPE	A	B	C	D	E	F	G	CTN	KG
G33	20NB	19	54	33	40	31	35	5	80	16
G34	25NB	25	54	33	40	31	35	5	80	20
G35	32NB	32	63	42	40	31	35	5	50	17

BOLT ON GUDGEONS - Galvanised

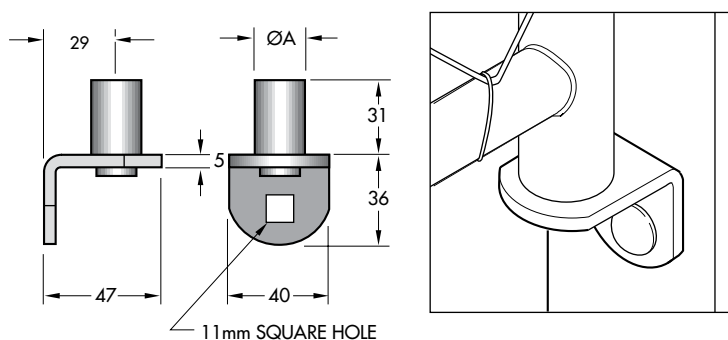

CODE	PIPE	A	CTN	KG
G40	20NB	20	80	15
G41	25NB	25	70	16
G42	27NB	27	60	16
G43	32NB	32	40	13

CHANNEL GUDGEONS - Weld on - Galvanised

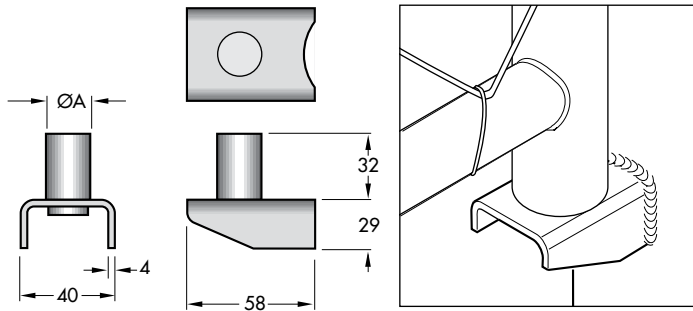

CODE	PIPE	A	CTN	KG
PG20	20NB	19	40	8
PG25	25NB	25	70	17
PG27	32NB	27	70	18

SHORT PLATE WOOD GUDGEON - Galvanised

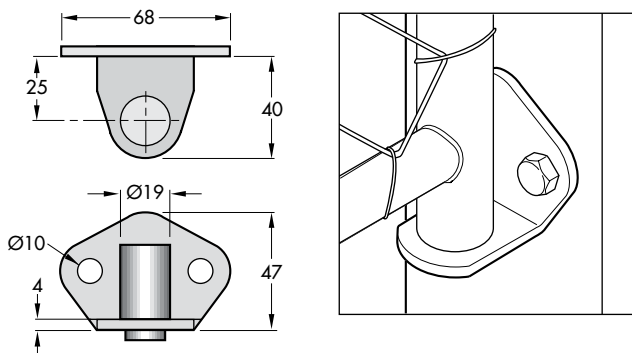

CODE	PIPE	CTN	KG
G17	20NB	80	14

- Suits timber posts.

LOOSE BOLT GUDGEONS - Galvanised

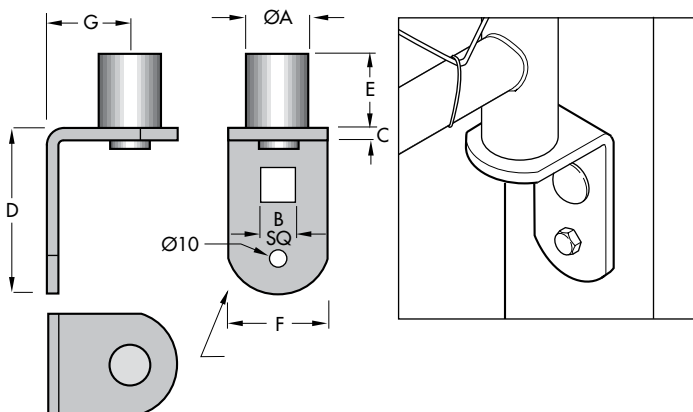

CODE	PIPE	A	B	C	D	E	F	G	CTN	KG
G22	25NB	25	17SQ	5	68	31	40	31	60	17
G23	32NB	32	17SQ	5	68	31	40	30	50	17
G24	20NB	20	17SQ	5	68	31	40	33	60	17

- Case Hardened Solid Steel Construction (50x5).
- Totally protects pad lock hasp.
- Uses existing padlocks and suits most double and single gates.
- Australian Patent 668956 – USA Patent 5544505.

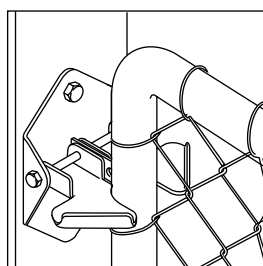

- Catch can be made 'one way' by moving the locking fixture to one end.

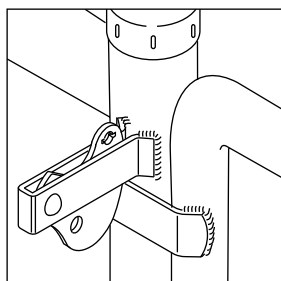

- For use on round pipe.

A technical line drawing of a door handle assembly. It shows a horizontal handle with a circular grip on the left and a spindle on the right. The spindle is inserted into a lock mechanism within a door frame. The drawing includes hatching to indicate the internal components of the lock and the door frame.

23

'D' LATCH HANDLES - Zinc Plated

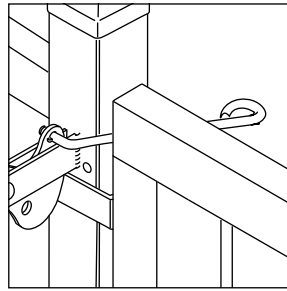
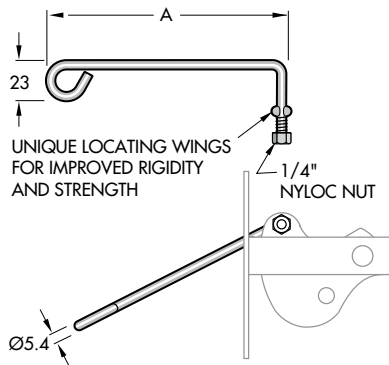

CODE	A	CTN	KG
TB28-170-BG	170	60	2
TB28-230-BG	230	60	3.1

- Used when access to catch from the other side of gate is required.
- Improved strength through unique positive locating and locking method.
- Suits left and right hand installations.

BOLT-ON 'D' LATCHES & STRIKERS - Flat - Zinc Plated, Gal. & S/Steel

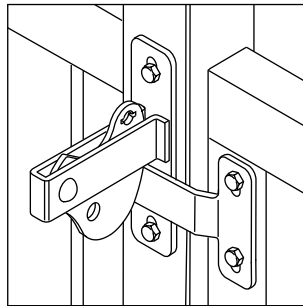
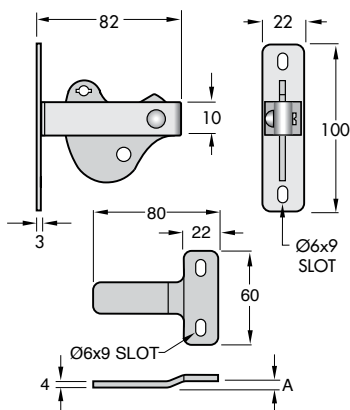

CODE	TYPE	A	FINISH	CTN	KG
CAC28	LATCH	-	ZINC PLATED	60	13
CAC28G	LATCH	-	GALVANISED	60	14
BTS28	STRIKER	3	ZINC PLATED	60	4
BTS28G	STRIKER	3	GALVANISED	60	4
BTS29	STRIKER	15	ZINC PLATED	60	3

BOLT-ON 'D' LATCH & STRIKER - Round - Zinc Plated

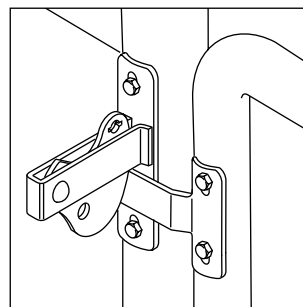
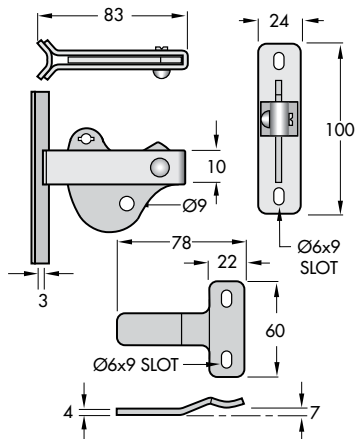

CODE	DESCRIPTION	CTN	KG
CAC29	LATCH	60	13
BTS28R	STRIKER	60	4

STRIKER ANTI RATTLE SLEEVE - Black Vinyl

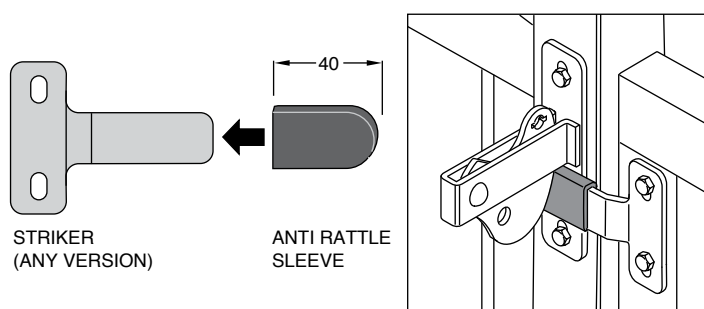

STRIKER
(ANY VERSION)

ANTI RATTLE
SLEEVE

CODE	PACK	KG
SARS-BG	60	4

- Reduces latch rattle and striker noise.
- Suits all 'D' Latch Strikers.
- Can be used on existing and new installations.

'D' LATCH ANGLE BRACKET - Zinc Plated

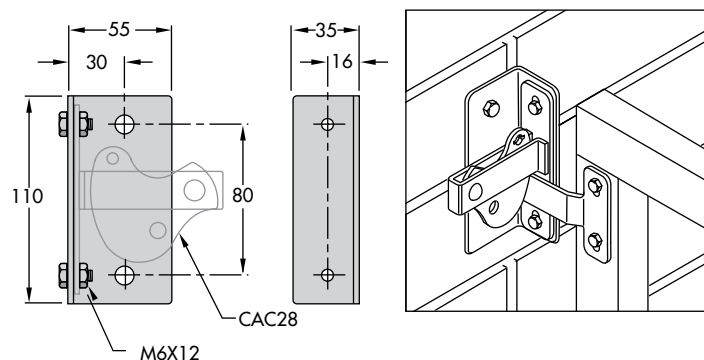

M6X12
CAC28

CODE	CTN	KG
AB28	25	6

- Used on brick and masonry walls and posts as both a stop and a catch.
- Two M6x12 bolts and nuts supplied in pack.

FORTE HAPSLOCK - Stainless Steel Hasp & Lock



REGULAR MODEL



SINGLE HINGE MODEL



DOUBLE HINGE MODEL



ROUND GATE MODEL



BLIND COVER

CODE	DESCRIPTION	SIZE	KG
FHLSSR-L	REGULAR MODEL	530x67mm	1.45kg
FHLSSSH-L	SINGLE HINGE MODEL	530x85mm	1.85kg
FHLSSDH-L	DOUBLE HINGE MODEL	260x85mm	2.25kg
FHLSSRGP-L	ROUND GATE MODEL	530x67mm	1.74kg
FHLSSBC	BLIND COVER	60x80mm	0.11kg

FORTE PULL BOLT - Stainless Steel - Face Mount - Key Lockable



CODE	DESCRIPTION	SIZE	CTN
FPBSSM	PULL BOLT - SURFACE MOUNT	92x100mm	6
FPBSSFM	PULL BOLT - FLUSH MOUNT	92x100mm	6

BROADHURST LOCK KITS

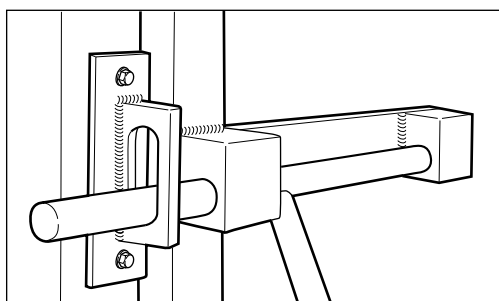

CODE	DESCRIPTION	CTN
BHLDL	DOUBLE LOCK BOX KIT	EACH
BHLLB	LOCK BOX ONLY	EACH

CONTENTS: DOUBLE LOCK BOX KIT

2 x Lock Boxes, 1 x Slide Bar, 1 x Slide Bar Catch For Single Gate,
1 x Slide Bar Catch For Double Gates, 1 x Lock Box Plate

As Illustrated:

Double lock box installation for single gate.

Bolt can be locked in open & closed position.

SECURITY SLIDING GATE LOCK

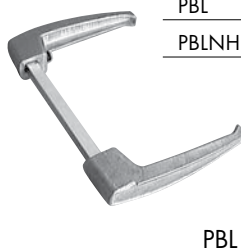
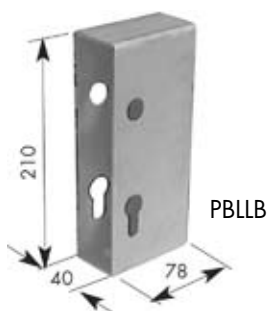

CODE	DESCRIPTION	CTN
PBL01	PARROT BEAK SECURITY LOCK + STRIKER	EACH
PBLLB	LOCK BOX TO SUIT PBL01	EACH
PBL	ALLOY HANDLE KIT TO SUIT PBL01	EACH
PBLNH	HANDLE KIT TO SUIT PBL01	EACH

JACKSONS MORTISE LATCH & LOCK - 5 Lever

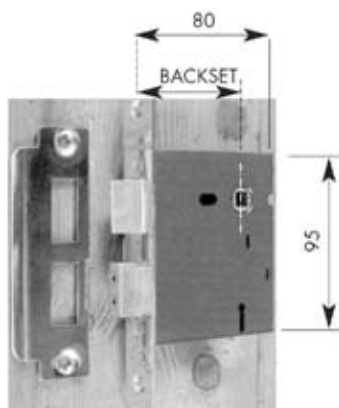

CODE	DESCRIPTION	CTN
JM25-LOCK	30mm BACKSET	EACH
JM25-LIKE	30mm BACKSET - 2 x KEYED ALIKE	2
JM546-LOCK	46mm BACKSET	EACH
JM546-LIKE	46mm BACKSET - 2 x KEYED ALIKE	2
JM560-LOCK	60mm BACKSET	EACH
JM560-LIKE	60mm BACKSET - 2 x KEYED ALIKE	2

- Highly pick resistant 5 lever lock.
- 2 keys supplied.
- Backset is measurement from face plate to centre of lever socket.

JACKSONS MORTISE DEAD LOCK - 5 Lever

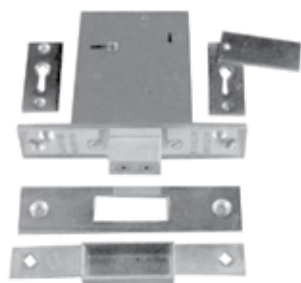

CODE	DESCRIPTION	CTN
JM29-LOCK	60mm BACKSET	EACH
JM29-LIKE	60mm BACKSET - KEYED ALIKE	EACH

- Highly pick resistant 5 lever lock.
- 2 keys supplied.

JACKSON MORTISE CAGE - Fully Welded Mild Steel

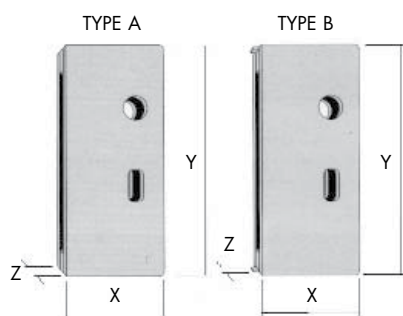

CODE	SUIT LOCK	X	Y	Z
TYPE A				
JM560-CAGE	JACKSON JM560	97	176	26.5
JM25-CAGE	JACKSON JM25	65	176	26.5
LOCKWOOD	LOCKWOOD 570	95	175	29.5
TYPE B				
JM29-CAGE	JACKSON JM29	94	119	25
JM546-CAGE	JACKSON JM546	81	159	25

HANDLE - To Suit Steel Privacy Gate



CODE	DESCRIPTION	FINISH	CTN
1590	Latch Tongue/Handle Only	ZINC PLATED	EACH

- Latch tongue used to latch and lock around post.

LOCK & HANDLE - To Suit Steel Privacy Gate

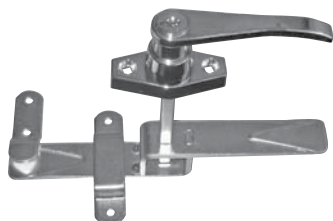

CODE	DESCRIPTION	CTN
G62	CHROME	EACH

- Includes locking handle, latch/rear handle, guide, keeper and screw
- 2 keys supplied.

SECURA-GATE SPRING LOADED GATE LOCK - ZINC PLATED

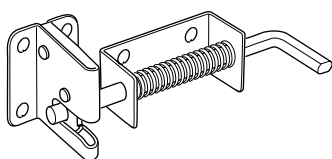

CODE	DESCRIPTION	CTN
P705L	SPRING LOADED LOCK + GRAVITY LATCH	EACH

ANTI BURGLAR "D" LATCH - Stainless Steel



CODE	DESCRIPTION	CTN
GRAMLS	LATCH & STRIKER	EACH
RGRAMHAN	HANDLE - UNIVERSAL (LEFT OR RIGHT)	EACH

COIL TYPE SPRING - Zinc Plated



CODE	DESCRIPTION	CTN
G305	360mm LONG	EACH

- Tension Adjuster and Lock Pin

HASP & STAPLE - Heavy Duty - Zinc Plated

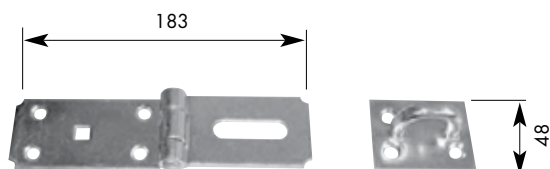

CODE	DESCRIPTION	CTN
G58	HASP & STAPLE WITH BRASS PIN	10

LOCK BLOCK - Anti Tamper Pad Lock Protection - Stainless Steel



CODE	DESCRIPTION	CTN
LB-1	PORTABLE ANTI TAMPER PAD LOCK COVER	32

- It fits most Padlocks from 30mm - 50mm.
- Designed and manufactured to give the padlock ultimate protection against bolt cutters.
- Uses include: motorbikes, gates, toolboxes, sheds, trailers and most places padlocks are used.

MASTERLOCK HIGH SECURITY GATE LOCK & HASP

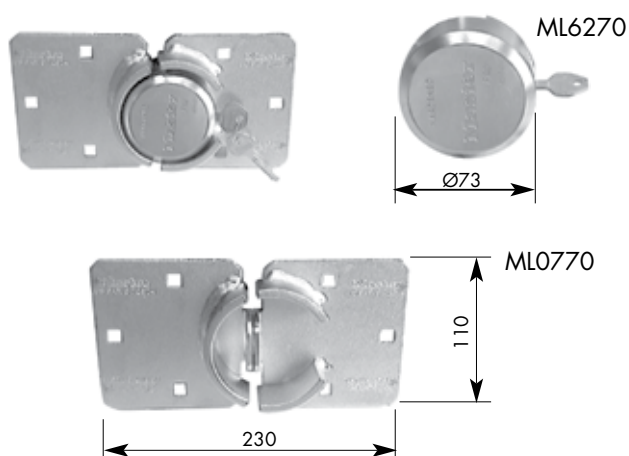

CODE	DESCRIPTION	CTN
ML6270	MASTERLOCK CONCEALED SHACKLE SECURITY LOCK EACH	
ML0770	MASTERLOCK SECURITY HASP TO SUIT ML6270	EACH
MLKA	SURCHARGE FOR KEYED ALIKE LOCKS	EACH
MLMK	SURCHARGE TO MASTER KEY LOCKS	EACH
MLAK	ADDITIONAL KEYS	EACH

SHOOT PADBOLT

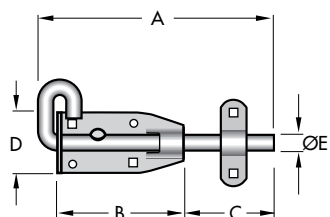

CODE	A	B	C	D	E	TYPE
ZINC PLATED						
G17G	100	65	25	32	9	SINGLE EYE
G18D	175	100	60	45	12.5	DOUBLE EYE
GPBL10	210	150	60	45	12.5	DOUBLE EYE
STAINLESS STEEL						
G17M	100	65	25	32	9	SINGLE EYE
G17N	120	65	25	32	9	SINGLE EYE
GALVANISED						
G17GGAL	100	65	25	32	9	SINGLE EYE
G18DGAL	150	100	60	45	12.5	DOUBLE EYE

LOCKABLE DROP BOLT - Zinc Plated / Stainless Steel

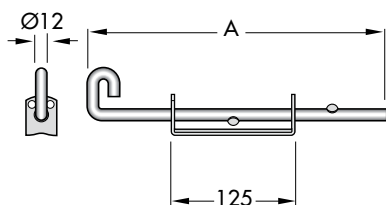

CODE	A	DESCRIPTION	CTN
GG450L	450	ZINC PLATED	40
GG650L	650	ZINC PLATED	40
SSDB300	300	STAINLESS STEEL	5
SSDB450	450	STAINLESS STEEL	5
SSDB650	650	STAINLESS STEEL	5

CHAIN - 25kg Drum



CODE	SIZE	DESCRIPTION	25kg DRUM
PCC03D25	Ø3mm LINK	GALVANISED	116m
PCC04D25	Ø4mm LINK	GALVANISED	76m
PCC05D25	Ø5mm LINK	GALVANISED	60m
PCC06D25	Ø6mm LINK	GALVANISED	30m
PCC08D25	Ø8mm LINK	GALVANISED	18.5m
PCC10D25	Ø10mm LINK	GALVANISED	12.2m
PCC13D25	Ø13mm LINK	GALVANISED	7mm

SIDE RELEASE GRAVITY LATCH - Spring Loaded - Zinc Plated

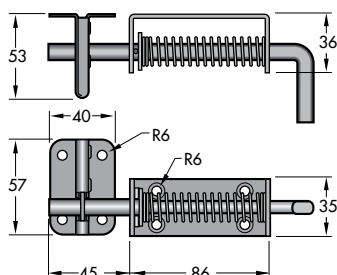
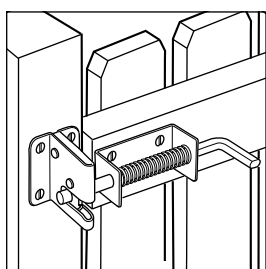

CODE	CTN	KG
P705L	30 EACH	12

- Supplied complete with 8 off timber fixing screws.

DOUBLE GATE BOW - Galvanised

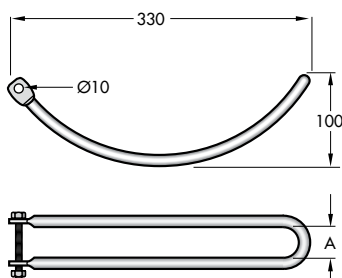
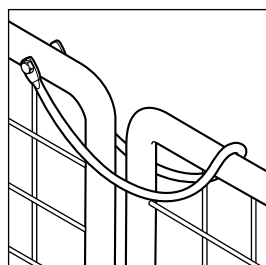

CODE	PIPE	A	BOLT	CTN	KG
CAC22	20-25NB	40	M8 x 50	20	14

- Galvanised bolt and nut supplied.

LOKK LATCH DELUXE - Privacy & Security Latch

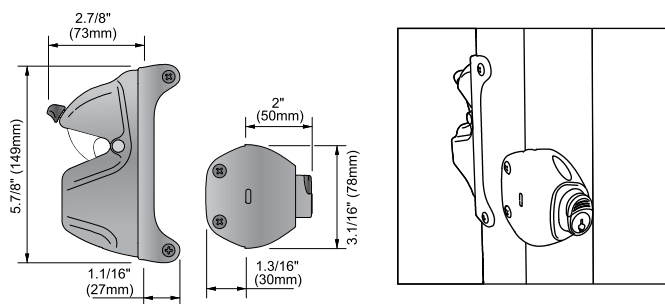

CODE	DESCRIPTION	CTN
LLDAB-L2	Lokk Latch Deluxe	15

* Locks and operates from both sides of the gate.
Can be keyed to the front door.

Z-LOKK - Magnetic Gate Lock

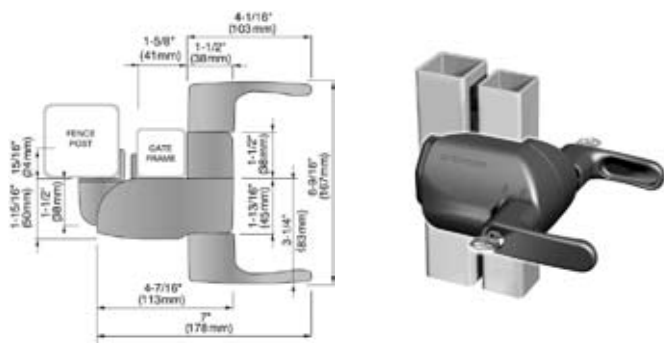

CODE	GATE FRAME	CTN
ZL1-L	25-41mm	10
ZL2-L	44-63mm	10

* No milling, hole drilling or welding.
* Self latches even in locked position.
* Dual Key 6 pin security locking cylinders
* Patented magnetic action.
* Fits left and right handed hinged gates.
* Fully adjustable.

GATE STOPS - Soft & Quiet Gate Stops

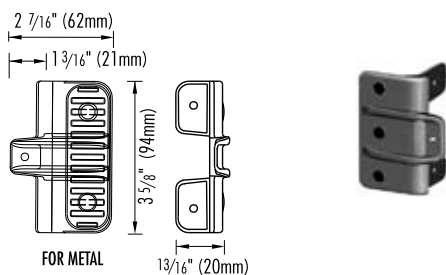

CODE	TO SUIT	SIZE	CTN
TCGS2	Timber/Heavy Metal Gates	120x93mm	60
TCGS3	Light Metal Gates	94x62mm	100

LOKK-BOLT - Security Drop Bolt - Key Lockable

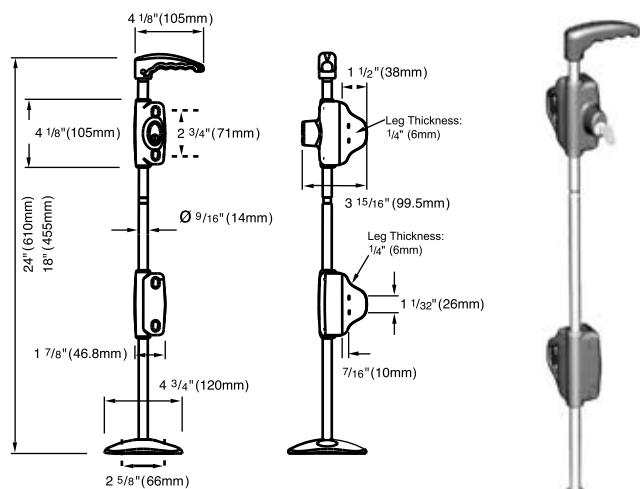

CODE	DESCRIPTION	CTN
LB118BX-L	18" (457mm) METAL GATE	10
LB124BX-L	24" (610mm) METAL GATE	10
*LBBPBG	MOULDED BASE PLATE - SUITS ALL MODELS	-

* Non stock item. Available to order only. Minimum order one (1) carton.

DROP BOLTS - Galvanised

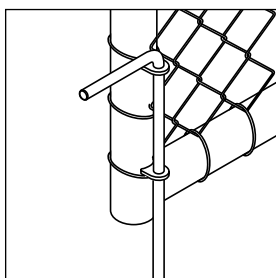

CODE	A	B	C	CTN	KG
GDB265	12	265	85	50	16
GDB370	16	370	85	25	18
GDB430	20	430	85	10	15
GDB600	16	600	85	10	15
GDB846	16	846	85	10	15

FLAG PIN DROP BOLTS - Galvanised

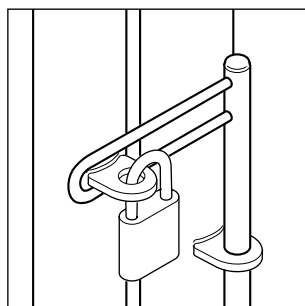
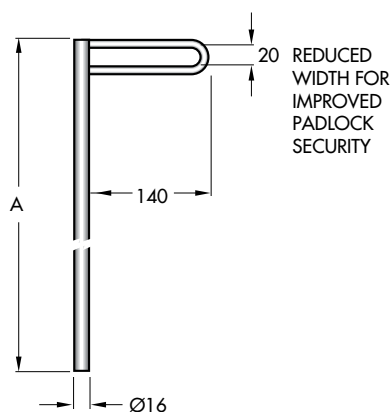

CODE	A	SUITABLE LUGS	PACK	KG
FPDB900-BG	900	L2, L2B, L7, L7B	10	16
FPDB1050	1050	L2, L2B, L7, L7B	10	18
FPDB1200-BG	1200	L2, L2B, L7, L7B	10	20
FPDB1500	1500	L2, L2B, L7, L7B	10	25

Note: Lugs not included.

SECURITY DROP BOLTS - Galvanised

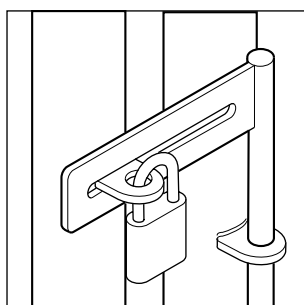
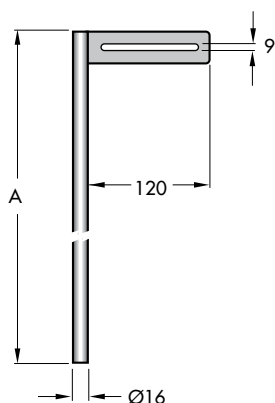

CODE	A	SUITABLE LUGS	PACK	KG
FPDS900	900	L2, L2B, L7, L7B	10	16
FPDS1200	1200	L2, L2B, L7, L7B	10	20
FPDS1400	1400	L2, L2B, L7, L7B	10	25

Note: Lugs not included.

DROP BOLT LUGS - Round - Galvanised & Black

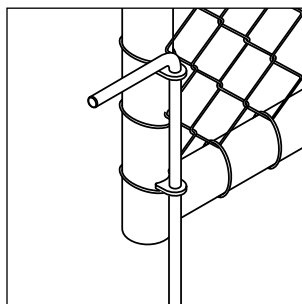
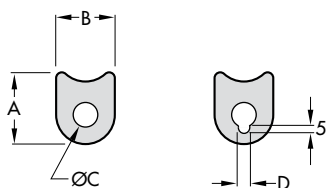

CODE	A	B	C	D	FINISH	CTN	KG
L1	38	30	13	5	GALVANISED	250 PAIR	18
L2	38	30	17	6	GALVANISED	250 PAIR	14
L3	48	35	21	8	GALVANISED	250 PAIR	20
L1B	38	30	13	5	BLACK	250 PAIR	17
L2B	38	30	17	6	BLACK	250 PAIR	14
L3B	48	35	21	8	BLACK	250 PAIR	20

- Sold in pairs (1 x plain + 1 x slotted).

DROP BOLT LUGS - Flat - Galvanised

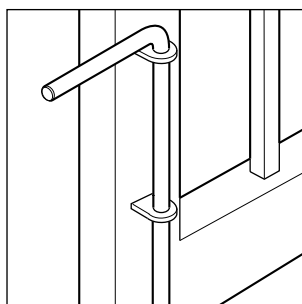
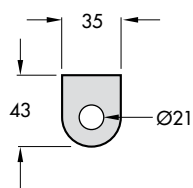

CODE	DESCRIPTION	CTN	KG
L3C	WELD ON LUG FOR FLAT SURFACES	250 PAIR	19

- Sold in pairs (2 x plain).

DROP BOLT LUGS - Wrought Iron - Galvanised - Black

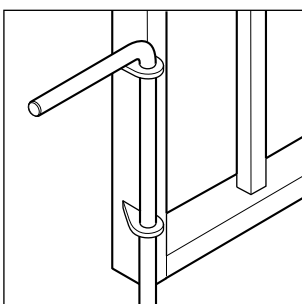
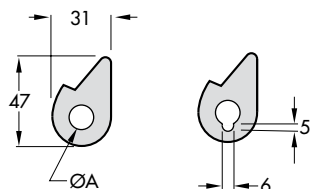

CODE	A	FINISH	CARTON	KG
L6B	13	GALVANISED	250 PAIR	18
L7	17	GALVANISED	250 PAIR	16
L6B	13	BLACK	250 PAIR	17
L7B	17	BLACK	250 PAIR	16

- Sold in pairs (1 x plain + 1 x slotted).

DROP BOLT + SLIDE PLATES - Zinc Plated & Galvanised

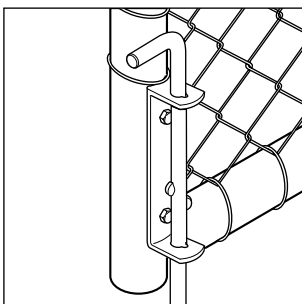
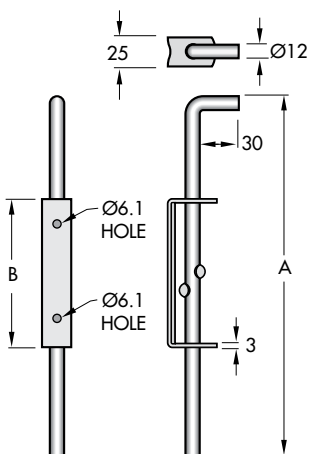

CODE	A	B	FINISH	CARTON	KG
DROP BOLTS + SLIDE PLATE - BOLT ON					
B11	275	127	ZINC PLATED	40	15
B12	310	127	ZINC PLATED	40	16
B14	410	185	ZINC PLATED	40	21
B14G	410	185	GALVANISED	40	22
SLIDE PLATES ONLY					
B11/12-2	-	127	ZINC PLATED	100	10
B14-2	-	185	ZINC PLATED	100	13
B14-2G	-	185	GALVANISED	100	13

- Use on both round and flat section.

DROP BOLT + SLIDE PLATES - Locking - Zinc Plated - Galvanised

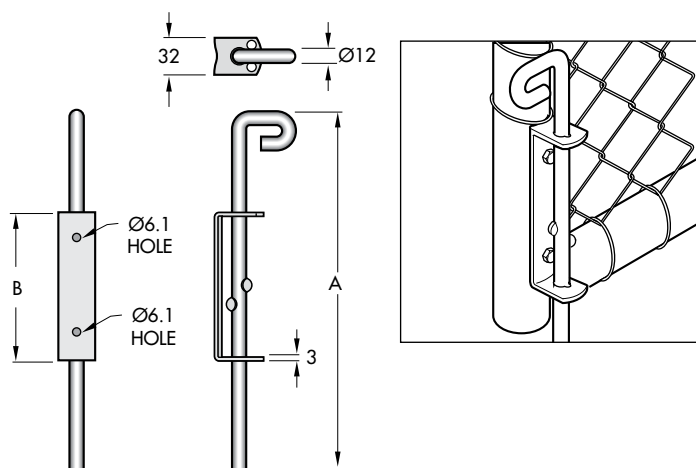

CODE	A	B	FINISH	CARTON	KG
DROP BOLTS + SLIDE PLATES					
B13L	310	127	ZINC PLATED	40	18
B15L	400	185	ZINC PLATED	40	24
B15LG	400	185	GALVANISED	40	24
SLIDE PLATES ONLY					
B13L-2	310	127	ZINC PLATED	40	18
B15L-2	400	185	ZINC PLATED	40	24
B15L-2G	400	185	GALVANISED	40	24

- Improved design.
- Use on both round and flat section.

SHOOT BOLT + SLIDE PLATES - Locking - Galvanised

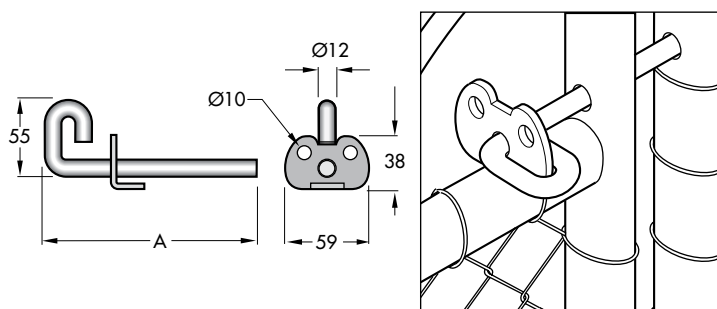

CODE	A	CTN/PACK	KG
B8	152	60(2X30)	18
B9	305	40(2X20)	17

GATE PAD BOLTS - Locking - Zinc Plated

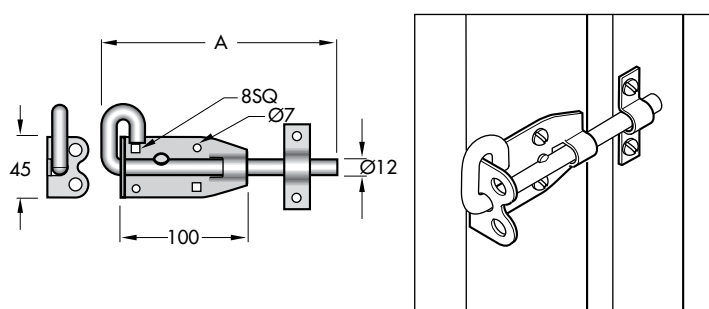

CODE	A	CTN/PACK	KG
G18D	190	40(40X1)	5
GPBL10	270	40(40X1)	8

GATE BRACE - Galvanised

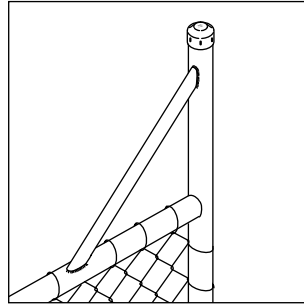
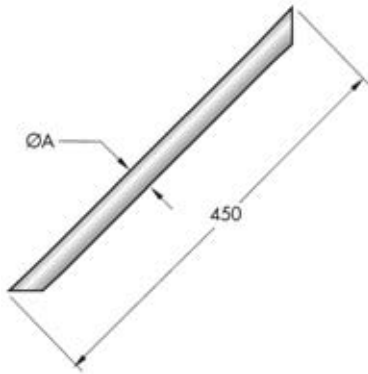

CODE	A	DESCRIPTION	CTN	KG
GB12	Ø12	Ø12 BAR BRACE	35	14

GATE ENTRY BRACE - Galvanised

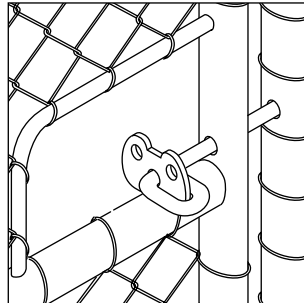
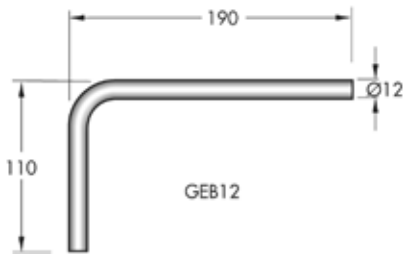

CODE	A	DESCRIPTION	CTN	KG
GEB12	Ø12	BAR ENTRY BRACE	60	15

5 WHEEL CARRIAGES - Small (M), Medium (P), Large (G)

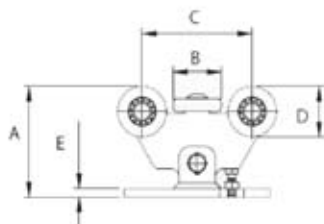

CODE	A	B	C	D	E	KG
CGS-350M	132	60	136	60	10	5.4
CGS-350P	166	89	222	89	10	10.7
CGS-350G	246	126	343	126	10	37

8 WHEEL CARRIAGES - Small (M), Medium (P), Large (G)

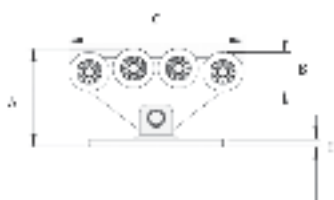

CODE	A	B	C	E	KG
CGS-350.8M	138	55	235	10	6.5
CGS-350.8P	166	79	300	10	12
CGS-350.8G	246	117	498	10	44

GUIDES - Small (M), Medium (P), Large (G)

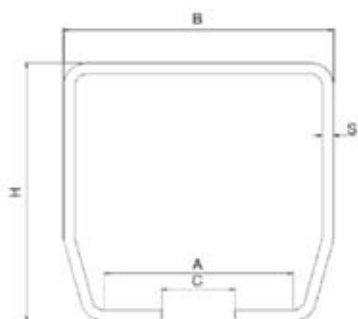

CODE	A	B	C	H	S	KG
CGS-345M	48	68	23	68	3.5	18.25
CGS-345P	66.5	100	33	89	5	35
CGS-345G	98	140	38	140	6	67

• 3m length

CODE	A	B	C	H	S	KG
CGS-345M-6	48	68	23	68	3.5	36.5
CGS-345P-6	66.5	100	33	89	5	70
CGS-345G-6	98	140	38	140	6	134

• 5.8m length

END WHEELS - Small (M), Medium (P), Large (G)

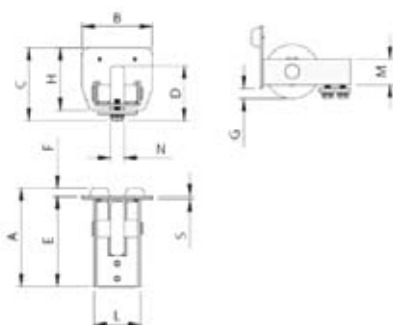

CODE	A	B	C	D	E	F	G	H	L	M	N	S	KG
CGS-347M	135	68	82.5	68	123	12	14.5	68	45	32	15	4	1
CGS-347P	14	100	104	78	129	12	15	89	66	37	20	4	1.7
CGS-347G	195	140	155	98	170	24.5	15	140	95	56	30	5	4.15

END BRACKETS - Small (M), Medium (P), Large (G)

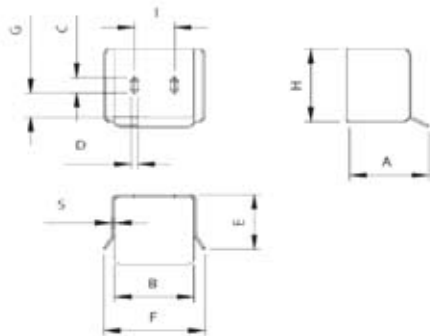

CODE	A	B	C	D	E	F	G	H	I	S	KG
CGS-346M	104	78	25	9	75	114	25	91	38	4	1.15
CGS-346P	119	112	30	11	84	154	33	112	50	4	1.8
CGS-346G	159	154	35	13	120	197	55	165	77	5	38

DOUBLE ROLLERS ADJUSTABLE

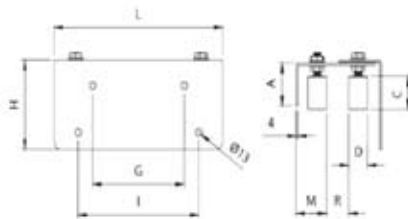

CODE	A	C	D	G	H	I	L	M	KG
CG-251	74	58	40	190	154	230	350	44-88	6.7

SINGLE ROLLER

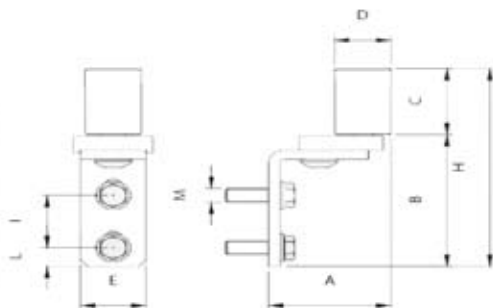

CODE	A	B	C	D	E	H	I	L	M	KG
CG-252	55-85	109	57	40	46	167	53	16	M12	0.8

SINGLE ROLLER - 'U' VERSION - Small (M), Medium (P)

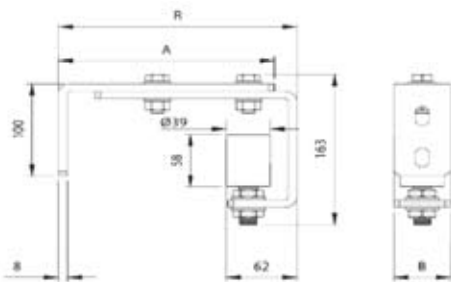

CODE	A	B	R	KG
CG-253M	165	50	165-185	2
CG-253P	190	50	185-215	2.1

CANTILEVER GATE COMPONENTS LIST

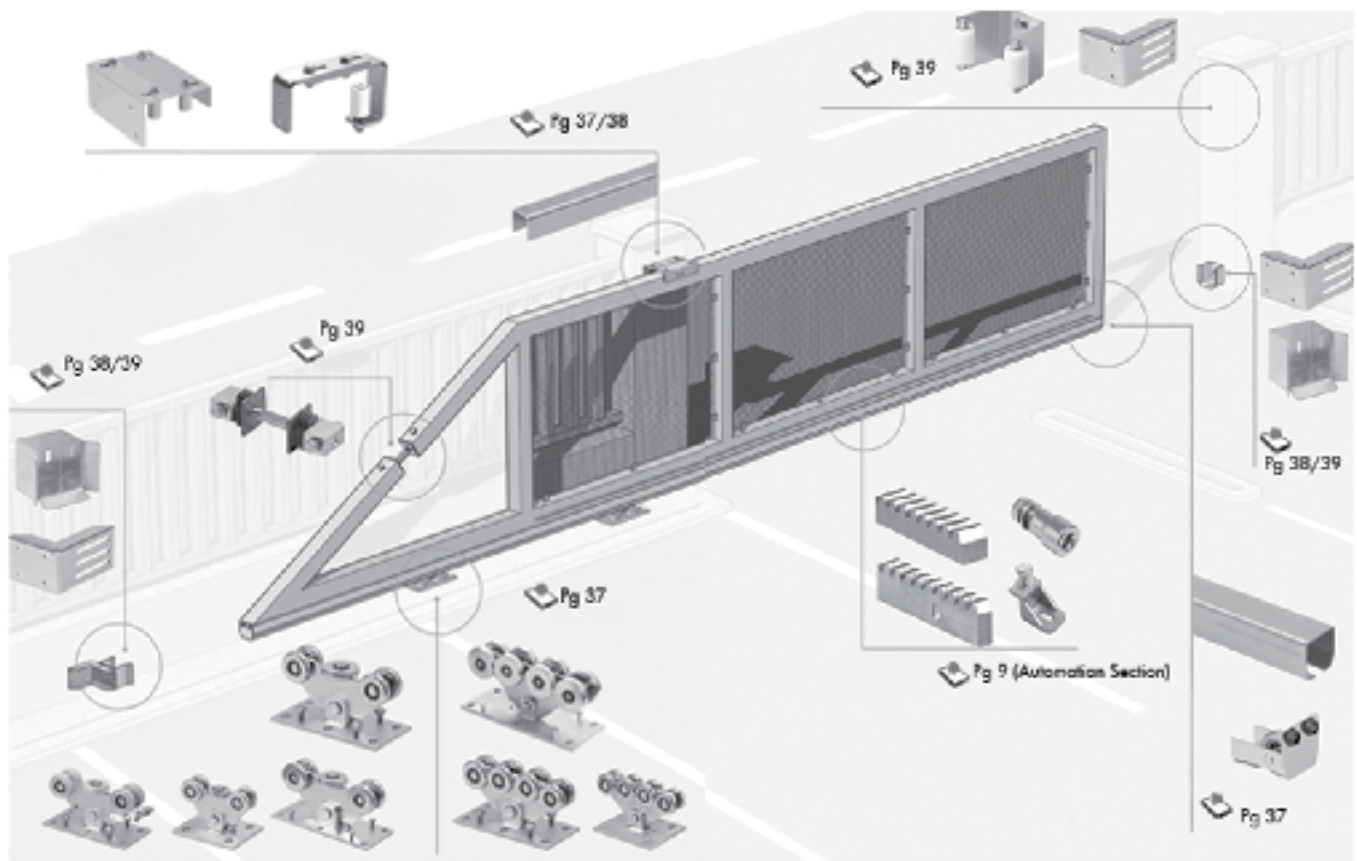

20MM BOLT DOWN TRACK - GALVANISED

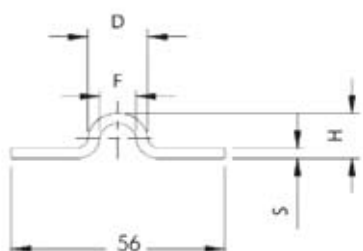

CODE	D	F	H	S
SGT3*	19.5	13.5	16	3
SGT4**	19.5	13.5	16	3
SGT6***	19.5	13.5	16	3

*3M

**4M

***6M

20MM CONCRETE EMBEDDING TRACK - GALVANISED

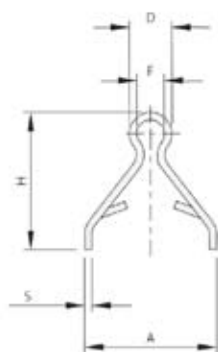

CODE	A	D	F	H	S
287/20CT*	58	19	13	55	3

*3M

20MM JOINER FOR 287/20CT - GALVANISED

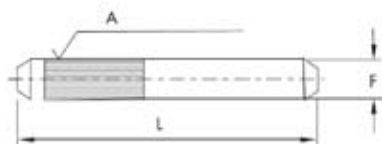

CODE	A	F	L
300504	11.5	11	90

20MM BOLT DOWN TRACK - ALUMINIUM

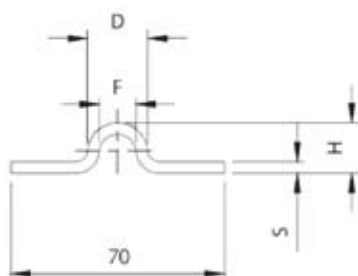

CODE	D	F	H	S
SGTA6*	19.5	3.75	5	4.75

*6M

2 BALL BEARING WHEEL WITH SUPPORT - 20mm Track

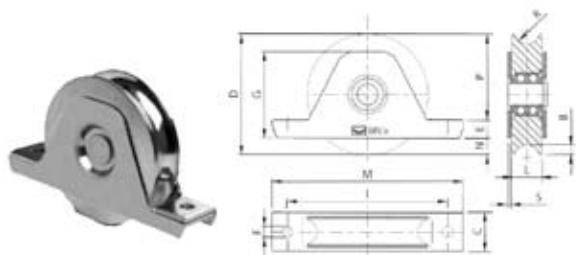

CODE	SIZE	B	C	D	E	F	G	I	L	M	N	P	R	S
300550	90	8	32	88	14.5	9	55.5	130	24	155	9	64.5	10.5	3
430/100	100	8	32	98	14.5	9	55.5	130	24	155	14	69.5	0.5	3
300551H	120	9.5	37	117	15	9	65	155	28	185	16.5	85.5	10.5	3

GROOVE: ROUND

- Code 300550 each wheel certified for 300Kg
- Code 430/100 each wheel certified for 380Kg
- Code 300551H each wheel certified for 400Kg

2 BALL BEARING WHEEL WITH SUPPORT - V Groove Track

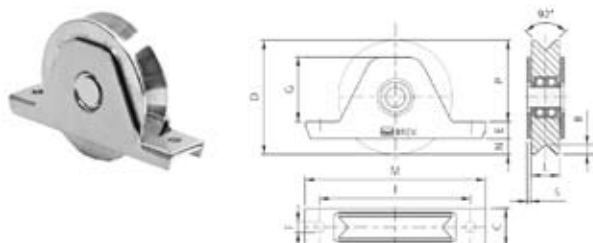

CODE	SIZE	B	C	D	E	F	G	I	L	M	N	P	S
336-90	90	8.5	32	88	14.5	9	55.5	130	24	155	9	64.5	3

GROOVE: V

- Each wheel certified 300Kg

1 BALL BEARING WHEEL WITH EXTERNAL SUPPORT - 20mm Track

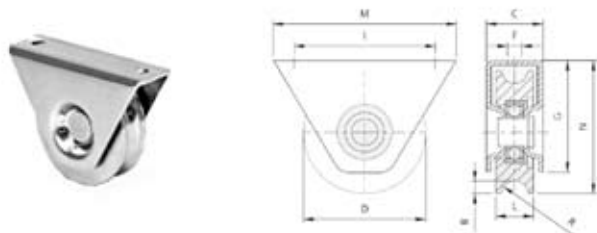

CODE	SIZE	B	C	D	F	G	I	L	M	N	R
327-80S	90	9.5	36	78	9	71	90	24	117	84.5	10.3

GROOVE: ROUND

- Each wheel certified 200Kg

2 BALL BEARING WHEEL ONLY - 20mm Track

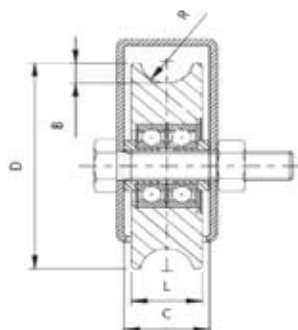

CODE	GROOVE	SIZE	B	C	D	L	R
300551	Round	120	9.5	34	117	28	10.5
300552	Round	160	9.5	44	157	33	11.5
300553	Round	200	9.5	44	197	33	11.5

- Code 300551, each wheel certified for 420Kg
- Code 300552, each wheel certified for 560Kg
- Code 300553, each wheel certified for 600Kg

1 BALL BEARING WHEEL WITH SUPPORT - 20mm Track

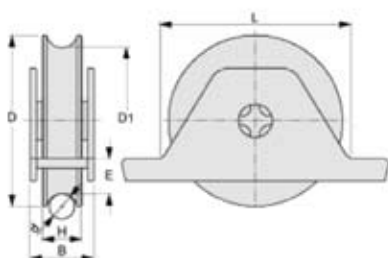

CODE	D	D1	d	B	H	E	L
300550B	90	72	20	33	24	17	97

- Each wheel certified for 200Kg

1 BALL BEARING WHEEL WITH SUPPORT - 16mm Track

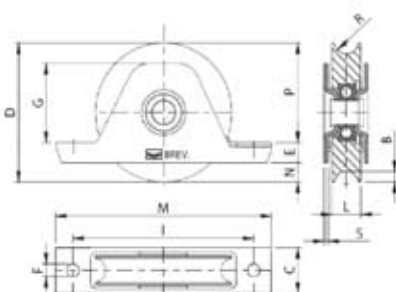

CODE	B	C	D	E	F	G	I	L	M	N	P	R	S
337-90	7.5	32	88	14.5	9	55.5	130	21	155	8.5	65	8.5	3

- Each wheel certified 190Kg

GREASE GUN TWIN WHEELS - 20mm Track

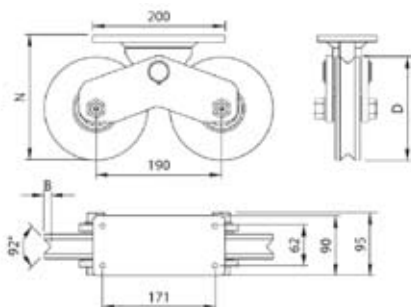

CODE	D	N	R
339-120	117	170	10.5

- 4 Ball bearing each set
- Suitable for very heavy gate - each set certified for 1200Kg

40MM X 60MM WHITE THREAD 16

CODE	A	D	L	M
300558	58	39	98	M16

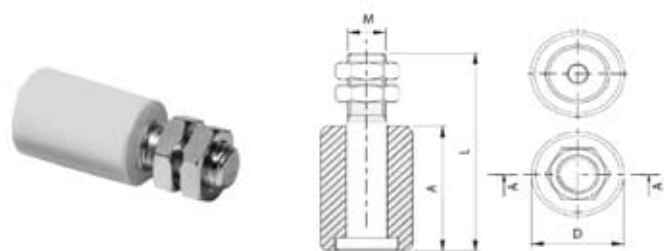

37MM X 36MM WHITE THREAD 10

CODE	A	C	D	L	M
300557	28	7	34.5	45-50	M10

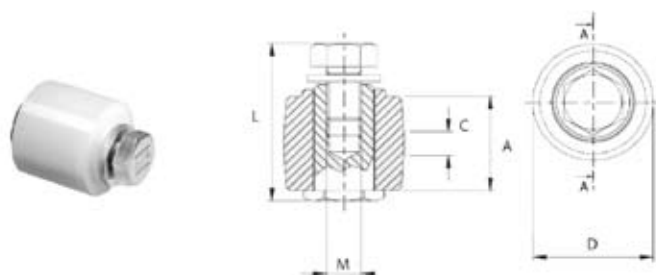

30MM X 40MM WHITE THREAD 14

CODE	A	D	L	M
23030	40	30	74	M16

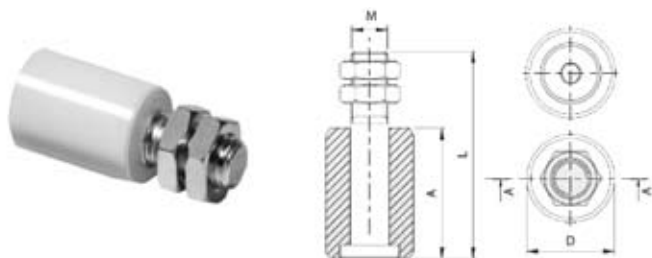

GUIDE BLOCK AND 2 VERTICAL GUIDES - For Sliding Gates

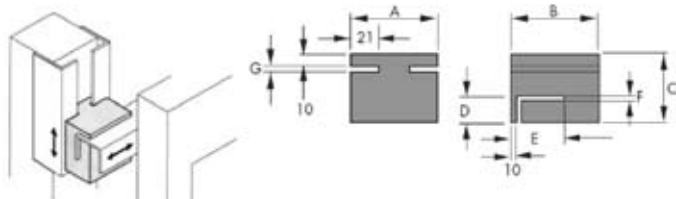

CODE	A	B	C	D	E	F	G
080MR30	75	76	78	23	46	4	5
NYBLOC	98	92	59	49	63	8.5	8.5

BIG NYLON ROLLER

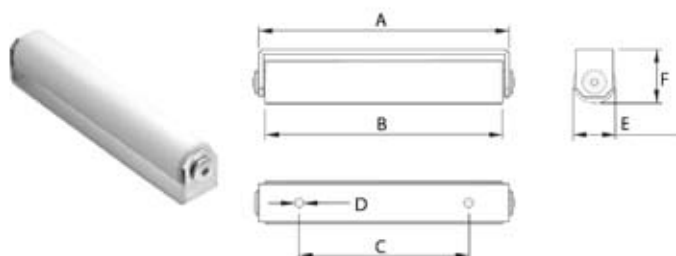

CODE	A	B	C	D	E	F
253-40	236	224	160	9	40	51

ADJUSTABLE GUIDING PLATE WITH 4 WHITE ROLLERS

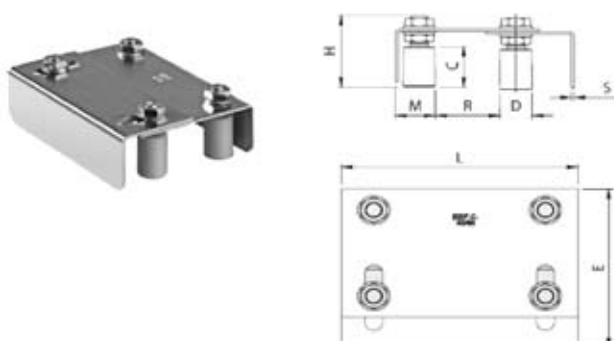

CODE	C	D	E	H	L	M
25530	40	30	135-175	74	220	38

GATE STOP TO WELD ON

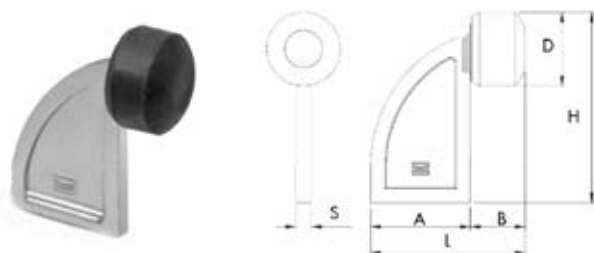

CODE	A	B	D	H	L	S
300507	50	27	37	96	77	8

GATE STOP TO BOLT ON

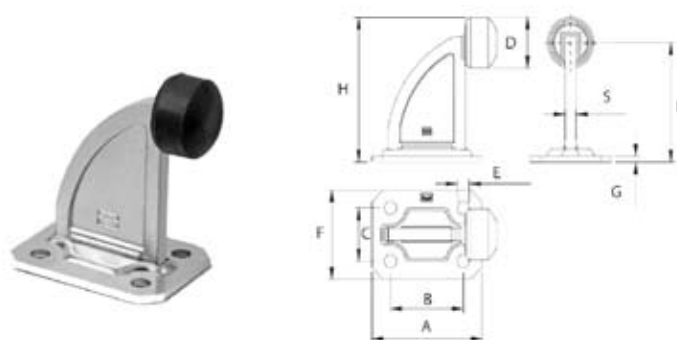

CODE	A	B	C	D	E	F	G	H	I	S
300507B	100	66	44	42	11	74	5	120	99	10

SLIDING GATE COMPONENTS LIST

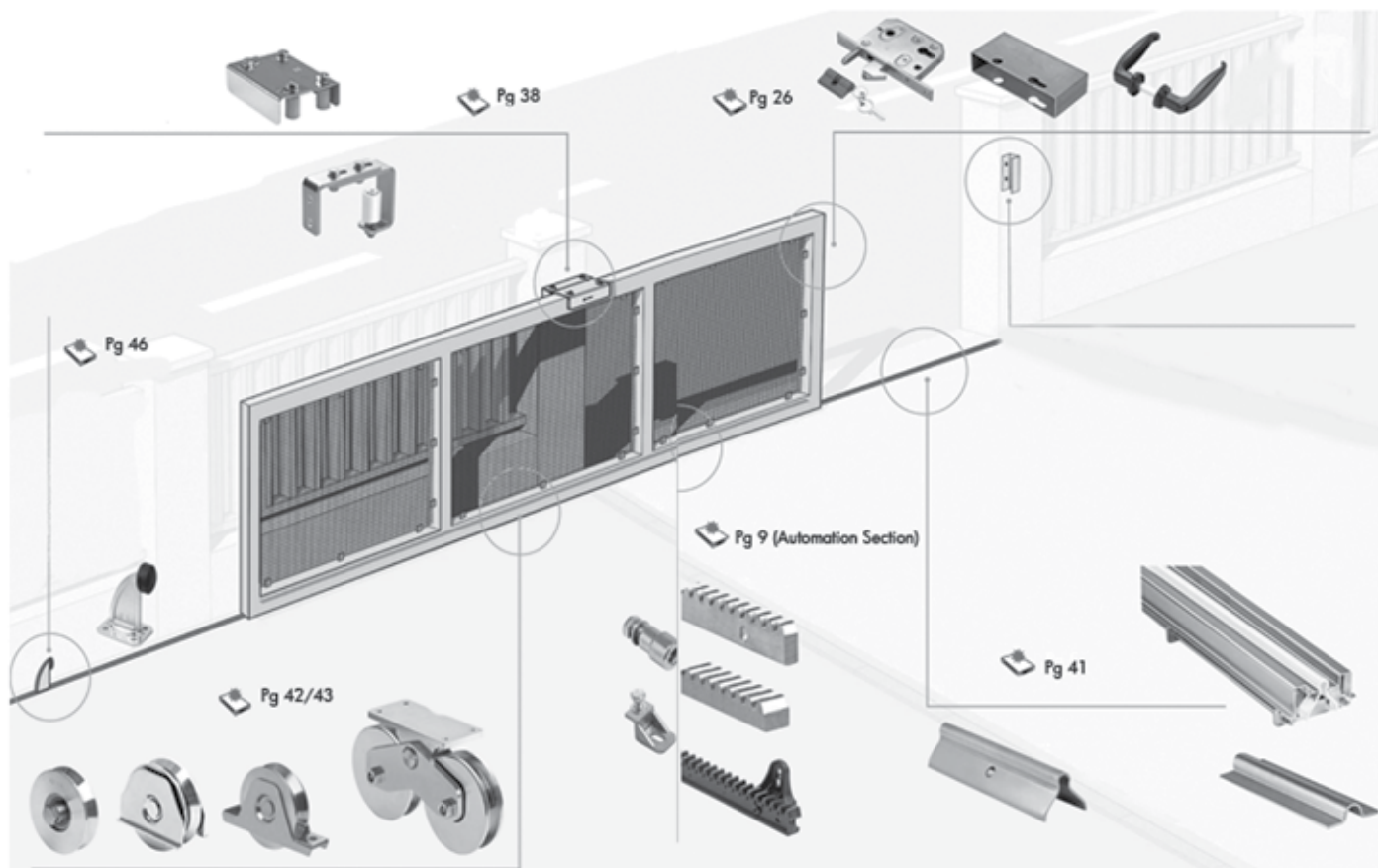

Downee® Swing Gate Hardware-Ball Bearing Hinges

Effective February 2009

UPPER HINGE WITH L PLATE

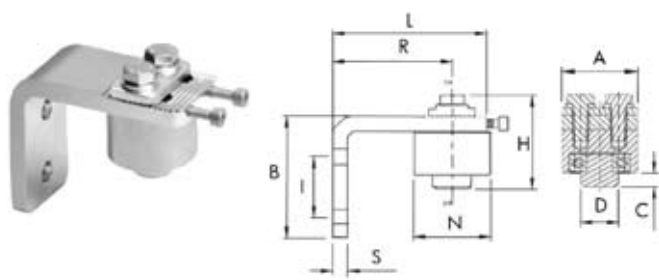

CODE	A	B	C	D	H	I	L	N	R	S	KG
85L-M	50	90	9	25	62	45	100	50	70-85	10	1.2
85L-G	60	110	15	35	72	55	130	70	90-105	10	2.1

UPPER HINGE DOUBLE ADJUSTMENT WITH PLATE

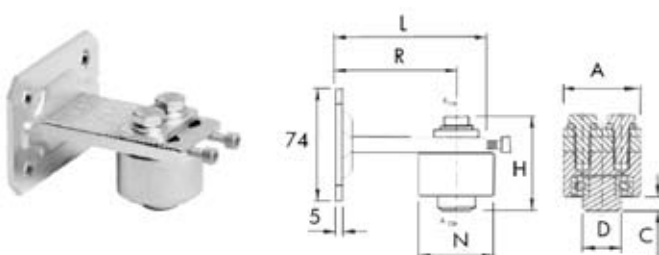

CODE	A	C	D	H	L	N	R	KG
85PST-M	50	9	25	62	100	50	70-85	1.15
85PST-G	60	15	35	72	130	70	90-105	1.6

UPPER HINGE DOUBLE ADJUSTMENT WITH PLATE

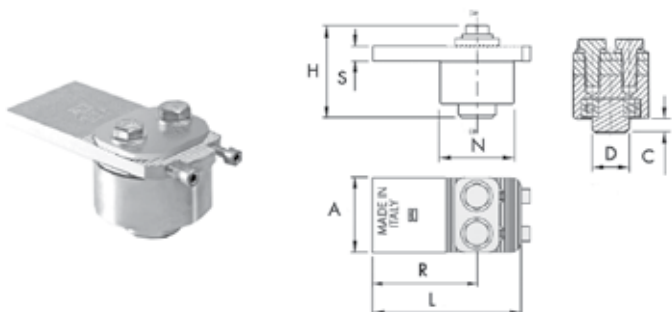

CODE	A	C	D	H	L	N	R	S	KG
85W-M	50	9	25	62	100	50	70-85	10	0.88
85W-G	60	15	35	72	130	70	90-105	10	1.6

UPPER HINGE WITH PLATE

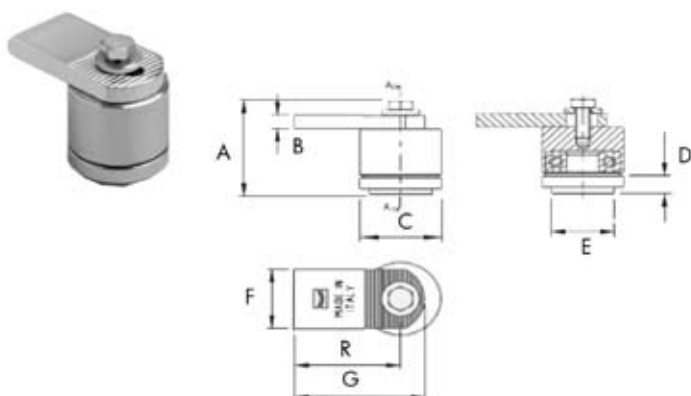

CODE	A	B	C	D	E	F	G	R	KG
86W-P	56	8	45	11	35	35	70	50-60	0.58
86W-G	72	10	70	15	35	60	130	90-105	1.6

*For Ball Bearing Hinges capacity see diagram on page - 53

© COPYRIGHT 2009 DOWNEE

ALL DIMENSIONS IN MILLIMETERS UNLESS OTHERWISE STATED SPECIFICATIONS SUBJECT TO CHANGE WITHOUT NOTICE

Downee®
A Division of
RMD Industries Pty Ltd
ABN 31 004 313 937

downtee.com.au

Effective February 2009

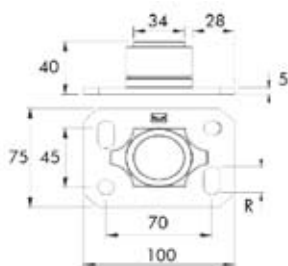

BOTTOM HINGE WITH THRUST BEARING & PLATE TO BE SCREWED

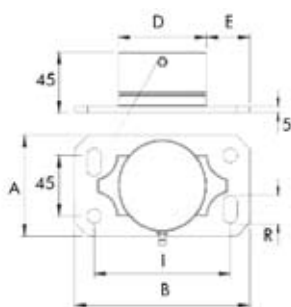

HEAVY BOTTOM HINGE WITH THRUST BEARING & PLATE TO BE SCREWED

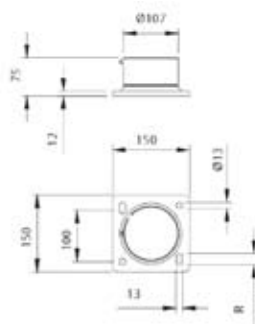

BOTTOM HINGE WITH THRUST BEARING

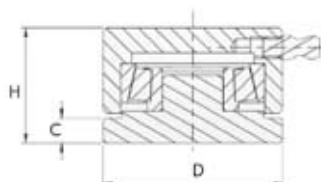

Downee®
A Division of
RMD Industries Pty Ltd
ABN 31 004 313 937

Downee® Swing Gate Hardware-Ball Bearing Hinges

Effective February 2009

BOTTOM HINGE WITH THRUST BEARING AND L PLATE

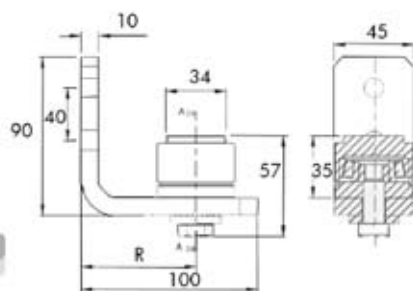

CODE	R	KG
87L-P	50 - 80	0.75

BOTTOM HINGE WITH THRUST BEARING AND L PLATE

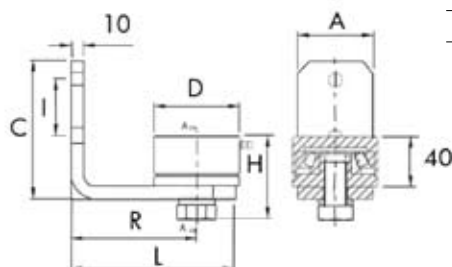

CODE	A	C	D	H	I	L	R	KG
87L-M	45	90	50	52	40	100	95-105	0.88
87L-G	60	110	70	66	55	130	95-105	2

HEAVY UPPER HINGE DOUBLE ADJUSTMENT AND PLATE

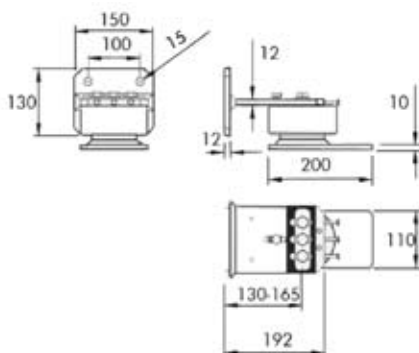

CODE	R	KG
85XL	130-165	10.2

UPPER HINGE WITH L PLATE

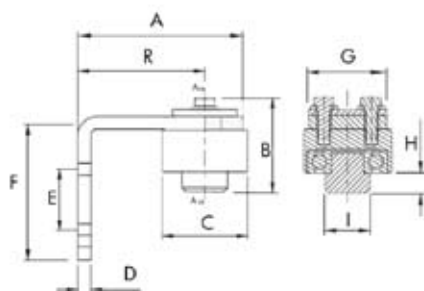

CODE	A	B	C	D	E	F	G	H	I	R	KG
86L-P	100	58	45	10	40	90	-	11	34	50-80	1
86L-G	130	72	70	10	55	110	60	15	35	90-105	4.2

*For Ball Bearing Hinges capacity see diagram on page - 53

© COPYRIGHT 2009 DOWNEE

ALL DIMENSIONS IN MILLIMETERS UNLESS OTHERWISE STATED SPECIFICATIONS SUBJECT TO CHANGE WITHOUT NOTICE

Downee®
A Division of
RMD Industries Pty Ltd
ABN 31 004 313 937

downee.com.au

CLAMP HINGE WITH GREASER & PLATE WITH ADJUSTABLE NUT

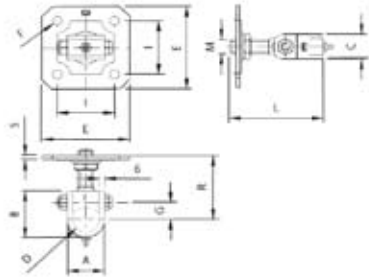

CODE	A	B	C	D	E	F	G	I	L	M	R	KG
186M22	47	60	35	35	100	11	23	65	122	M22	64-100	7.03

OVERSIZED HOLED PIVOT FOR CLAMP HINGES

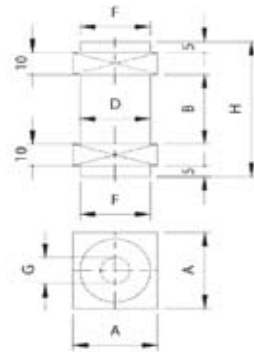

CODE	A	B	D	F	G	H	KG
192-35	40	37	34	34	16	67	0.59

PLATE WITH ADJUSTABLE NUT

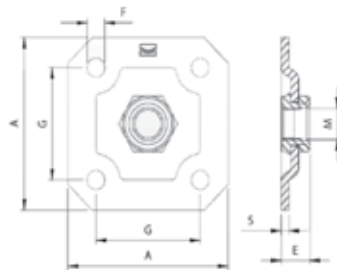

CODE	A	E	F	G	M	KG
159-M20	100	18	11	65	M20	0.45

ADJUSTABLE PINTLE HINGE M20 WELD ON 40MM X 30MM

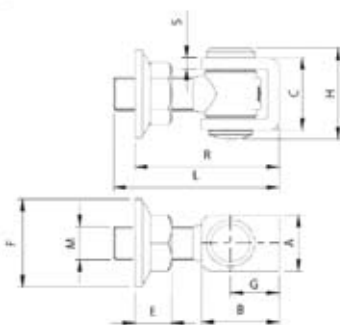

CODE	A	B	C	E	F	G	H	L	M	R	S	KG
15520	30	40	37	19	44	25	47	90	M20	70-90	5	0.45
15524	35	45	49	26	62	27	59	100	M24	75-100	6	0.82

HINGE WITH WING, BEARING AND PLATE

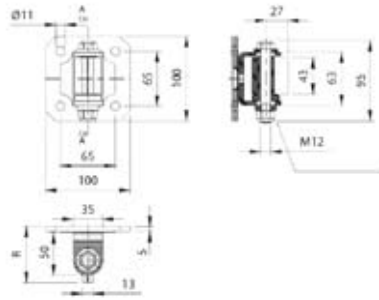

CODE	R	KG
96G	62-72	1

HINGE WITH WING AND PLATE

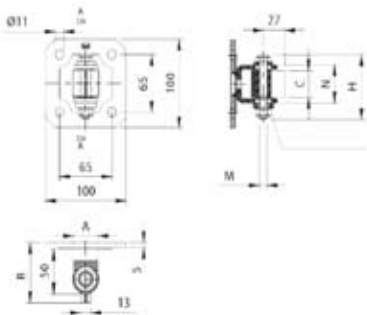

CODE	A	C	H	M	N	R	KG
94P	30	30	73	M10	43	63-73	0.79
94G	35	49	95	M12	63	62-72	0.96

GATE STOP TO BE FIXED

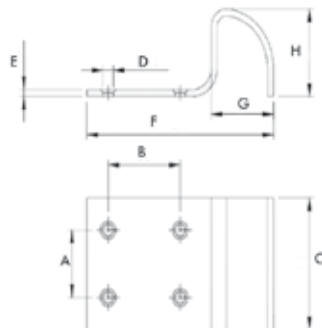

CODE	A	B	C	D	E	F	G	H	KG
171	46	58	90	8	5	150	50	60	0.82

GATE STOP TO CONCRETE IN

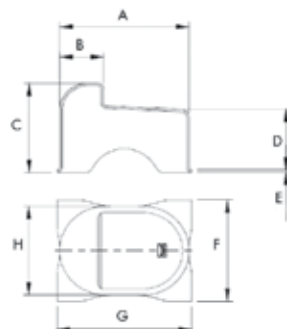

CODE	A	B	C	D	E	F	G	H	KG
300508	100	34	71	48	2	81	104	70	0.32

GATE STOP TO BOLT ON

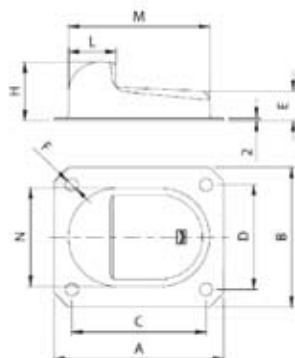

CODE	A	B	C	D	E	F	H	L	M	N	KG
300508B	120	100	95	75	21	9	42	34	100	70	0.30

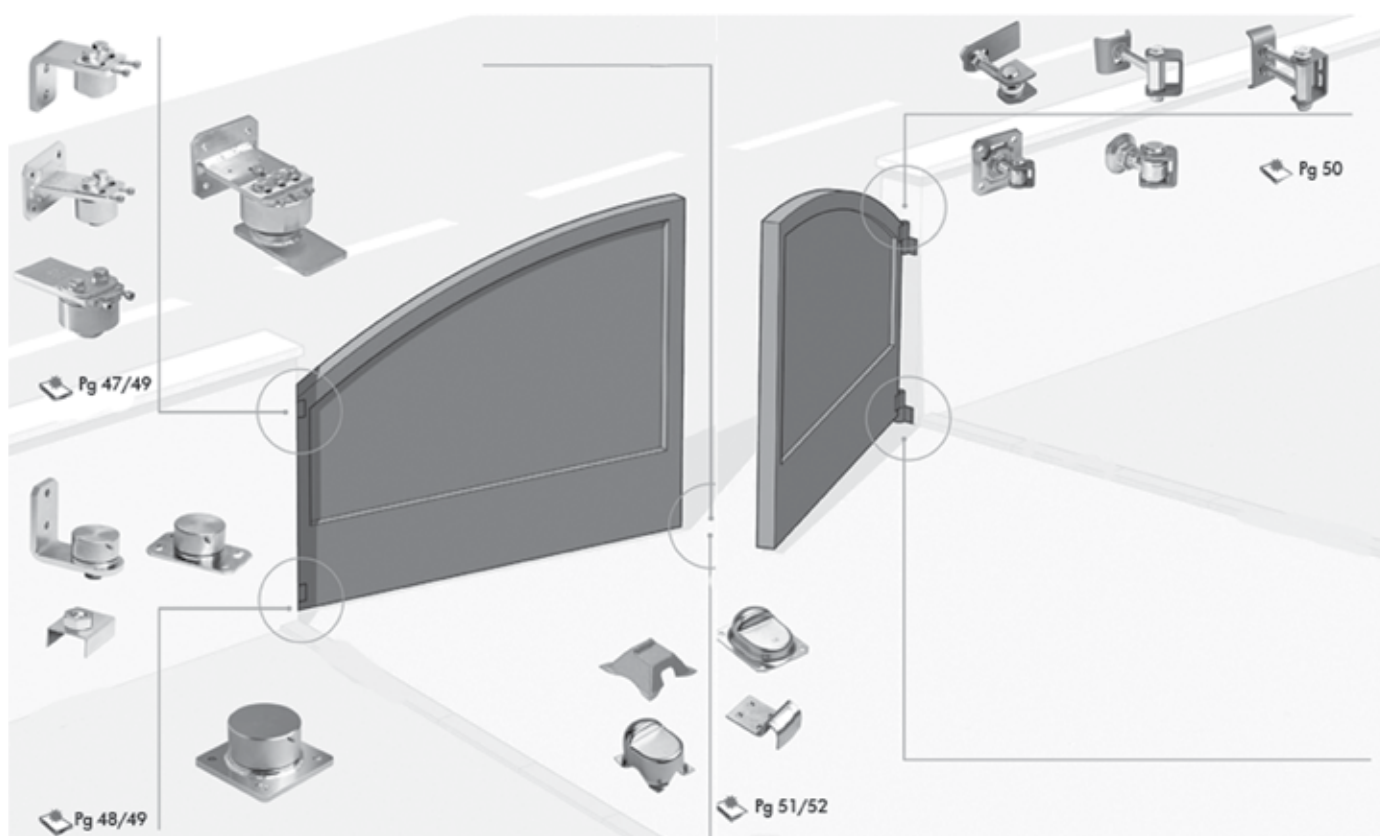

SWING GATE COMPONENTS LIST



Downee® Swing Gate Hardware-Ball Bearing Hinges

Effective February 2009

SELECTING THE RIGHT BALL BEARING HINGES

PAIR OF HINGES CAPACITY (Kg)				(top) code	85						86			
				type	PST		W		L		W		L	
					M	G	M	G	M	G	P	G	P	G
(bottom) code		type	size											
87		P			X	X	X	X	X	X	200	X	200	X
		PST	M		350	X	350	X	350	X	X	X	X	X
		G			X	500	X	500	X	500	X	500	X	500
		W	M		450	X	450	X	450	X	X	X	X	X
		G			X	550	X	650	X	650	X	650	X	500
		P			X	X	X	X	X	X	200	X	200	X
		L	M		350	X	350	X	350	X	X	X	X	X
		G			X	500	X	500	X	500	X	500	X	500

Example:

350Kg leaf on a concrete wall

Situation:

Top hinge to be bolt on the wall. Bottom hinge to be bolt on the ground.

Hinges of choice will be:

TOP: 85PST-M

BOTTOM: 87PST-M

FIXING TYPE:

PST = To Be Bolted

W = To Be Welded/Concreted In

L = (with L plate) to be bolted on

SIZE:

P = Small

M = Medium

G = Large

How To Get The Right Hinge:

1. Identify the product you are after by checking the possibility of connection and the leaf weight
2. Add the fixing type and the size to the code